

RESOLUTION NO. 2001-99

A RESOLUTION OF THE BOARD OF COUNTY COMMISSIONERS OF ST. JOHNS COUNTY, FLORIDA, AUTHORIZING THE CLERK OF COURTS TO FILE THE SURVEY MAP OF CRACKER SWAMP ROAD CLAIMING A VESTED INTEREST IN ST. JOHNS COUNTY IN THE RIGHT-OF-WAY DESCRIBED IN THIS SURVEY BY PRESCRIPTIVE RIGHTS OF THE PUBLIC PER CASE LAW BERGER VS. CITY OF CORAL GABLES 101 SO. 2d 396 (FLA. DIST. CT. APP.-3d DIST. 1958)

WHEREAS, the filing of the survey map with the Clerk of the Courts, the right-of-way as shown in this survey will be vested in St. Johns County, a political subdivision of the State of Florida by prescriptive rights of the public, per case law, Berger vs City of Coral Gable 101 So.2d 396 (Fla. Dist. Ct. App.-3d Dist. 1958), copy attached hereto and made a part hereof as Exhibit "A"; and

WHEREAS, Cracker Swamp Road as described and shown on the map, Exhibit "B", attached hereto and made a part hereof is one of the roads considered to be a County road; and

WHEREAS, Road and Bridge Supervisor, Frankie Hitchcock, has stated in a memo that Cracker Swamp Road has been maintained by the County and has been opened and used by the public for the last 24 years, copy attached hereto and made a part hereof as Exhibit "C"; and

WHEREAS, it is in the best interest of St. Johns County to acquire ownership of Cracker Swamp Road that will benefit the citizens of St. Johns County.

NOW, THEREFORE BE IT RESOLVED BY THE BOARD OF COUNTY COMMISSIONERS OF ST. JOHNS COUNTY, FLORIDA, as follows:

Section 1. All the above recitals are finds of fact.

Section 2. The Chair of the Board of County Commissioners and the Clerk of the Courts are hereby authorized to file the attached survey map of Cracker Swamp Road in the Public Records of St. Johns County, Florida.

PASSED AND ADOPTED, this 15th day of May, 2001.

**BOARD OF COUNTY COMMISSIONERS
ST. JOHNS COUNTY, FLORIDA.**

By: Mary F. Kohnke
Mary F. Kohnke, Chair

ATTEST: Cheryl Strickland, Clerk

Patricia DeGrande
Deputy Clerk



EXHIBIT "A" TO RESOLUTION

101 So. 2d 396, *; 1958 Fla. App. LEXIS 2691, **

Dora BERGER, Appellant, v. The CITY OF CORAL GABLES, Florida, a municipal corporation organized and existing under the laws of the State of Florida, and Dade County, a political subdivision of the State of Florida, Appellees.

No. 57-323.

District Court of Appeal of Florida, Third District.

101 So. 2d 396; 1958 Fla. App. LEXIS 2691

March 6, 1958.

CASE SUMMARY

PROCEDURAL POSTURE: Plaintiff grantee appealed the final decree of the Circuit Court for Dade County (Florida), which dismissed her suit to enjoin the public's continued use of a street.

OVERVIEW: Plaintiff grantee claimed to have title to the street in question because a tax deed purported to convey the property to plaintiff's son, who conveyed it to her. However, the tax deed and conveyance was based on a plat that did not place the street in its correct location. Plaintiff filed a suit to enjoin defendant city from continued use of the city street on the basis that title belonged to her. Uncontroverted testimony established that the property had been continuously used as a public street for 36 years. The circuit court dismissed plaintiff's suit. On appeal, plaintiff argued that the tax deed was prima facie evidence of title and that she took title free of any easements previously encumbering the land. The court stated that an easement by prescription was acquired when land was used by the public for a period of 20 years. The court thought that the established published easement took priority over the tax deed that plaintiff relied upon, especially because the deed stated that it was subject to existing easements.

OUTCOME: The court affirmed the dismissal of plaintiff grantee's suit to enjoin the public's use of a street because the public had acquired an easement by prescription that took priority over the tax deed that purported to grant title to plaintiff.

CORE TERMS: plat, street, easement, deed, grantee, tax deed, recorded, designated, dedication, discloses

CORE CONCEPTS - Hide Concepts

Real Property Law : Estates, Titles & Rights : Easements & Rights of Way
Governments & Legislation : Local Governments : Public Improvements & Services
Where land is used as a highway by the general public for a period of 20 years, the public acquires an easement to the same by prescription and a dedication of the land for such use is unnecessary.

COUNSEL: [1]**

Samuel B. Berger, Miami, for appellant.

Edward Semple, Miami, for City of Coral Gables.

Darrey A. Davis, Miami, for Dade County.

OPINION BY: CARROLL

OPINION: [*396] CARROLL, CHAS., Chief Judge.

This is an appeal from a final decree of the Circuit Court for Dade County, dismissing a suit to enjoin the continued use of a city street, title to which was claimed by the plaintiff-appellant.

The record on appeal discloses that the second amended plat of Cocoaplum Heights, recorded May 24, 1911, in Plat Book 1, at page 73 of the Public Records of Dade County, Florida, showed an unnamed 40 foot street. There was no dedication thereof. Uncontroverted testimony established that such property had been a roadway since 1915, and had been used continuously as a public street since then. On April 15, 1926, Coral Gables Corporation filed a plat designated as Coral Gables, Biscayne Bay Section, Part One, Plat E, which was recorded in Plat Book 25, at page 53. That 1926 plat showed a street designated as "Avenue Saldano", which appears to have been intended to be the street area involved here. However, through an error, the 1926 plat did not place the existing street where it actually [**2] was shown and located on the 1911 plat.

The record further discloses that on August 16, 1950, a plat of the F. H. Dunbar Tract was filed and recorded in Plat Book 51, at page 45. This 1950 plat showed the correct location of the street in question, as it had been shown originally on the 1911 plat.

Meanwhile, the tax assessors had used the 1926 plat as a basis for improper assessment of taxes on the actual street area. On the assumption that it had acquired title thereto through delinquency in such taxes, the Everglades Drainage District executed a deed (under Section 298.46, Fla.Stat., F.S.A., on April 27, 1951) to Samuel B. Berger, purporting to convey the property according to the erroneous 1926 plat. Appellant claims as grantee of the said Samuel B. Berger, who is her son.

[*397] Appellant raises two questions as follows:

1. Where the Trustees of Internal Improvement Fund or the Board of Commissioners of the Everglades Drainage District issue a tax deed, does it constitute prima facie evidence of title in the grantee?
2. Does a grantee of a tax deed take the title free of any easements previously encumbering the land?

It is settled in this state that where [**3] land has been used as a highway by the general public for a period of twenty years, the public acquires an easement to the same by prescription and a dedication of the land for such use is unnecessary. *Zetrouer v. Zetrouer*, 89 Fla. 253, 103 So. 625; *Couture v. Dade County*, 93 Fla. 342, 112 So. 75; *Dade County v. Snyder*, 140 Fla. 135, 191 So. 185; *Downing v. Bird*, Fla.1958, 100 So.2d 57; 17A Am.Jur., *Easements*, § 66, page 677.

The record shows that the parcel in question has been the subject of public user for street purposes for more than thirty-six years. After having appeared as such on the 1911 plat, its use for street purposes continued after 1926 in spite of the fact that the 1926 Coral Gables plat was inaccurate and did not show the true location of the street.

Aside from other reasons, the established public easement takes priority over the tax deed on which appellant relies, because the deed was made subject to easements. The deed states on its face that the conveyance is "Subject to all easements existing on the date of this deed."

The defendant Dade County claims no right in the street, and is interested only in seeing it maintained as a city street because it [***4] furnishes access to a county thoroughfare.

The action of the chancellor in dismissing the cause with prejudice on final hearing was without error.

Affirmed.

HORTON and PEARSON, JJ., concur.

Service: LEXSEE®
Citation: 101 So.2d 396
View: Full
Date/Time: Wednesday, February 28, 2001 - 9:43 AM EST

[About LEXIS-NEXIS | Terms and Conditions](#)

Copyright © 2001 LEXIS-NEXIS Group. All rights reserved.

CRACKER SWAMP ROAD HAS BEEN VESTED IN THE COUNTY IN ACCORDANCE WITH CHAPTER 95, F. S. (95.361) AS BY CERTIFIED BY:

ST. JOHNS COUNTY BOARD OF COUNTY COMMISSIONERS ST. JOHNS COUNTY CLERK OF COURTS

BOARD CHAIR

CLERK

MAP SHOWING A SPECIFIC PURPOSE SURVEY OF

A PORTION OF CRACKER SWAMP ROAD:
 SECTIONS 33, 34, & 38 TOWNSHIP 9 SOUTH, RANGE 28 EAST,
 SECTIONS 3, 4, & 37 TOWNSHIP 10 SOUTH, RANGE 28 EAST,
 ST. JOHNS COUNTY, FLORIDA

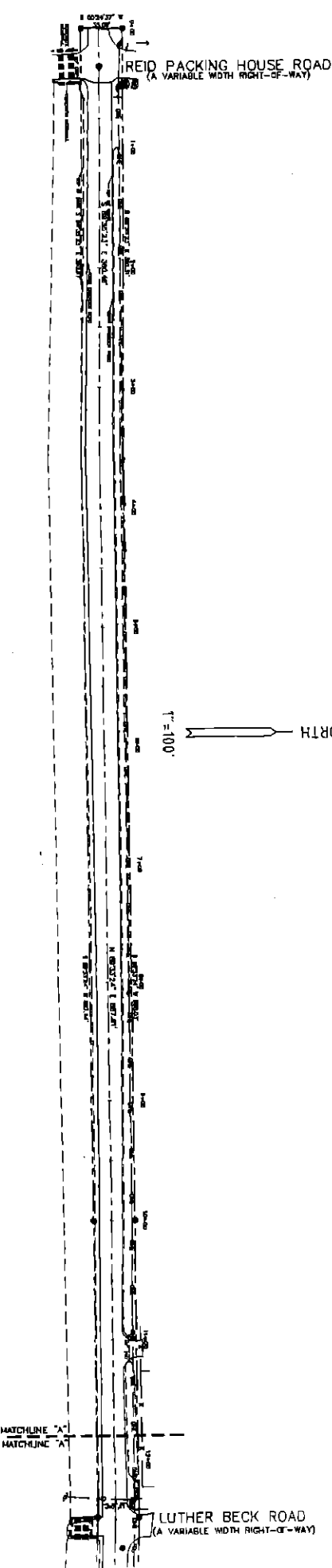

TABLE OF ABBREVIATIONS

PT - POINT OF TANGENCY	FP - FOUND ROOM PILE	● - RPPN MARKER FOUND IDENTIFICATION AS NOTED	— C/I — - CENTER LINE
PIC - POINT OF COMPOUND CURVATURE	FRB - FOUND REBAR	○ - 1/2" IRON PIPE SET I.B. MARK	— D/E — - OVERHEAD ELECTRIC LINE
PRC - POINT OF REVERSE CURVATURE	FRM - FOUND NAIL & DISC	□ - CONCRETE MONUMENT FOUND IDENTIFICATION AS NOTED	— O/T — - OVERHEAD TELEPHONE LINE
IR - RADIAL LINE	CSW - CONCRETE SIDEWALK	◇ - 5"x4" CONCRETE MONUMENT SET I.B. MARK	— B/E — - BUNDLED ELECTRIC LINE
PL - PLAT	LP - LIGHT POLE	RP - RADIUS POINT	— B/T — - BUNDLED TELEPHONE LINE
FC - CALCULATED	FP - FLAG POLE	B/W - RIGHT OF WAY	— V — - DENNETTS WATER LINE
GH - GROUND MEASURED	FM - FRONT MARK FOR SEWER SERVICE	R/R - BALGRADE	— G — - GAS LINE
OD - OBTED	CO - CLEAN-OUT FOR SEWER SERVICE	Δ - CENTRAL ANGLE	— F — - FENCE LINE
IZ - ZONING	CP - POWER POLE	Δ - RADIUS	— DOT — - DEPARTMENT OF TRANSPORTATION
RPPN - REBARMENT REFERENCE MONUMENT	QA - GUY WIRE & ANCHOR	⊖ - CHORD BEARING	— USL — - U.S. COAST & GEODETIC SURVEY
PRC - PERMANENT CONTROL POINT	UP - UTILITY POLE	⊕ - ARC LENGTH	— INVY - INCH ELEVATION
FCN - FOUND CONCRETE FOUNDMENT	WM - WATER METER	⊙ - POINT OF INTERSECTION	— O/R/V - OFFICIAL RECORDS VOLUME AND PAGES
TBN - TEMPORARY BENCHMARK	WV - WATER VALVE	PC - POINT OF CURVATURE	— FFL - FINISHED FLOOR ELEVATION
CPB - CORROGATED METAL PIPE	CP - CONCRETE PIPE		
⊕ - TEMPORARY BENCHMARK (TBM)			

GENERAL NOTES:
 1. BEARINGS ARE BASED ON THE SOUTHERLY RIGHT-OF-WAY LINE OF COUNTY ROAD 13 AS BEING NEPT 16.00' N.
 2. THIS IS A SPECIFIC PURPOSE SURVEY ONLY AND DOES NOT PURPORT ANY JURISDICTION OF ANY FEDERAL, STATE, COUNTY OR LOCAL AGENCY. THE PURPOSE OF THIS SURVEY IS TO ESTABLISH THE MAINLINE RIGHT-OF-WAY OF RANCH ROAD.
 3. THIS SURVEY WAS PREPARED WITHOUT THE BENEFIT OF ABSTRACT OR TITLE COMMITMENT. THIS COMPANY BEARS NO RESPONSIBILITY TO ANY CLAIMS MADE BY SUCH INSTRUMENTS.
 4. THIS SURVEY IS PREPARED AND CERTIFIED FOR THE EXCLUSIVE USE OF THE CLIENT NAMED HEREON AND IS NOT VALID WITHOUT THE SIGNATURE AND THE ORIGINAL RAISED SEAL OF A FLORIDA LICENSED SURVEYOR AND MAPPER.

"I HEREBY CERTIFY, that this map graphically depicts the results of a field survey made under my responsible direction and complies with the latest edition of the Minimum Technical Standards for Surveys as promulgated by the Florida State Board of Professional Regulation, Chapter 19, Part 1, Florida Statutes, subject to all notes and notations shown hereon.

FIELD SURVEYOR
ALBERT B. BRIDGMAN, P.E.
 LICENSED SURVEYOR NO. 6824

PRIVETT-NILES and ASSOCIATES, INC.
 SURVEYING AND MAPPING CONSULTANTS
 LICENSED BUSINESS # 6824
 3000 N. PONCE DE LEON BOULEVARD, SUITE "D"
 ST. AUGUSTINE, FLORIDA 32085 (904) 829-2591

CRACKER SWAMP ROAD HAS BEEN VESTED IN THE COUNTY IN ACCORDANCE WITH CHAPTER 95,
 F.S. (95.361) AS BY CERTIFIED BY:

ST. JOHNS COUNTY BOARD OF COUNTY COMMISSIONERS ST. JOHNS COUNTY CLERK OF COURTS

BOARD CHAIR

CLERK

MAP SHOWING A SPECIFIC PURPOSE SURVEY OF

A PORTION OF CRACKER SWAMP ROAD,
 SECTIONS 33, 34, & 38 TOWNSHIP 9 SOUTH, RANGE 28 EAST,
 SECTIONS 3, 4, & 37 TOWNSHIP 10 SOUTH, RANGE 28 EAST,
 ST. JOHNS COUNTY, FLORIDA

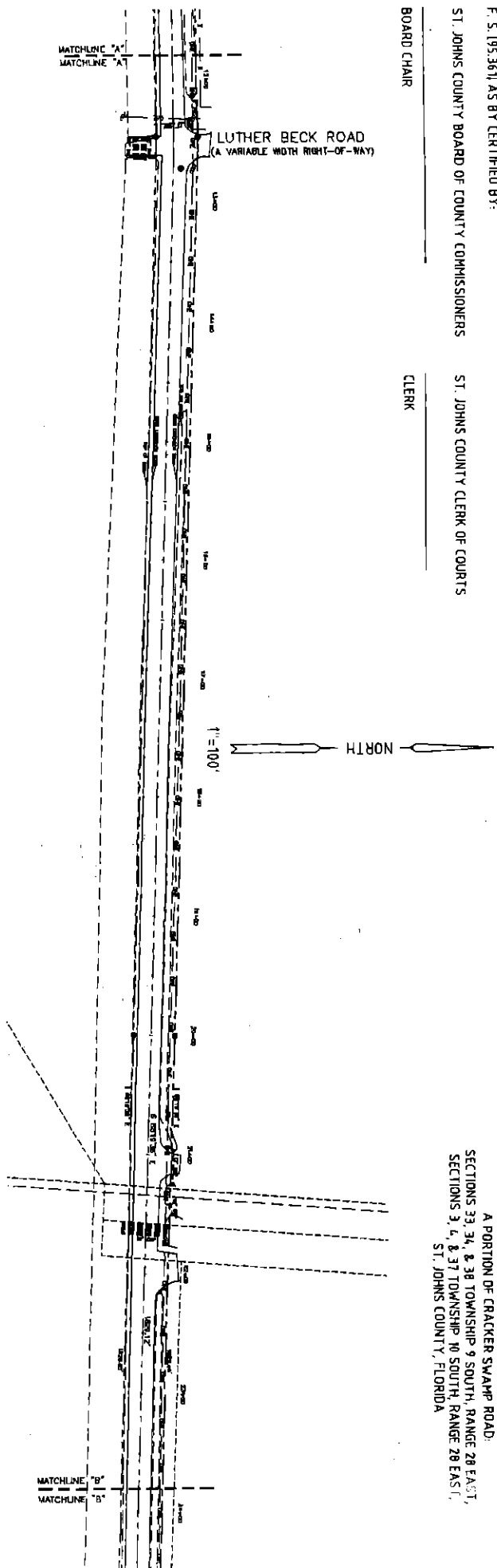

TABLE OF ABBREVIATIONS

- | | | | |
|--|---|---|--|
| <ul style="list-style-type: none"> PT - POINT OF TANGENCY PCC - POINT OF CURVATURE PRC - POINT OF REVERSE CURVATURE RI - RADIAL LINE PL - PLANT IC - CALCULATED HI - GROUND HIGHWAY LD - ROAD LD - ROAD PERM - PERMANENT BENCHMARK PCP - FOUND CONCRETE POINT TRM - TEMPORARY BENCHMARK CPM - CORRIGATED METAL PIPE DB - TEMPORARY BENCHMARK (TBM) | <ul style="list-style-type: none"> FP - FOUND IRON PIPE FMB - FOUND BENCH MARK FMD - FOUND METAL DISC CSW - CONCRETE SIDEWALK LP - LIGHT POLE FP - FLAG POLE FM - FORCE MAIN FOR SEWER SERVICE LD - CLEAN-OUT FOR SEWER SERVICE PP - POWER POLE GBM - BOLT WIRE & ANCHOR UM - UTILITY MARK MM - METAL MARK NY - NAIL IN WIRE CF - CONCRETE PIPE | <ul style="list-style-type: none"> ● - IRON MARKERS FOUND IDENTIFICATION AS NOTED ○ - 5/8" REBAR SET P.S.M. #2641 ■ - CONCRETE MONUMENT FOUND IDENTIFICATION AS NOTED □ - 4"x4" CONCRETE MONUMENT SET P.S.M. #2641 RP - RADIUS POINT B/W - RIGHT OF WAY B/R - RAILROAD R - RADIUS △ - CENTRAL ANGLE C - CHORD CB - CHORD BEARINGS L - ARC LENGTH PI - POINT OF INTERSECTION PC - POINT OF CURVATURE | <ul style="list-style-type: none"> — C/L — CENTER LINE — B/L — BREAK LINE — O/E — OVERHEAD ELECTRIC LINE — O/T — OVERHEAD TELEPHONE LINE — B/E — BURIED ELECTRIC LINE — B/T — BURIED TELEPHONE LINE — W — DENNETT'S WATER LINE — G — GAS LINE — F — FENCE LINE DOT - DEPARTMENT OF TRANSPORTATION USCLS - U.S. COAST & GEODETIC SURVEY NAVY - INVERT ELEVATION ORV - 46 - OFFICIAL RECORDS VOLUME AND PAGES FEL - FINISHED FLOOR ELEVATION |
|--|---|---|--|

GENERAL NOTES:

1. BEARINGS ARE BASED ON THE SOUTHERLY RIGHT-OF-WAY LINE OF COUNTY ROAD 13 AS BEING N87°16'00"W.
2. THIS IS A SPECIFIC PURPOSE SURVEY ONLY AND DOES NOT PURPORT ANY JURISDICTION OF ANY FEDERAL, STATE, COUNTY OR LOCAL AGENCY, THE PURPOSE OF THIS SURVEY IS TO ESTABLISH THE MAINTAINED RIGHT-OF-WAY OF RANCH ROAD.
3. THIS SURVEY WAS PREPARED WITHOUT THE BENEFIT OF ABSTRACT OR TITLE COMMITMENT. THIS COMPANY BEARS NO RESPONSIBILITY TO ANY CLAIMS MADE BY SUCH INSTRUMENTS.
4. THIS SURVEY IS PREPARED AND CERTIFIED FOR THE EXCLUSIVE USE OF THE CLIENT NAMED HEREON AND IS NOT VALID WITHOUT THE SIGNATURE AND THE ORIGINAL RAISED SEAL OF A FLORIDA LICENSED SURVEYOR AND MAPPER.

"I HEREBY CERTIFY, that this map graphically depicts the results of a field survey made under my responsible direction and complies with the latest Edition of Professional Surveyors and Mapmakers, Chapter 46817-4, Florida Administrative Code Pursuant to Section 471.027, Florida Statutes; subject to all rules and regulations above herein.

FIELD SURVEYOR'S SIGNATURE

ALBERT R. BAUDOUIN, P.E.M., LICENSED SURVEYOR NO. 5291

PRIVETT-NILES and ASSOCIATES, INC.

SURVEYING AND MAPPING CONSULTANTS

LICENSED BUSINESS # 8824

3000 N. PONCE DE LEON BOULEVARD, SUITE "D"
 ST. AUGUSTINE, FLORIDA 32085 (904) 829-2591

CRACKER SWAMP ROAD HAS BEEN VESTED IN THE COUNTY IN ACCORDANCE WITH CHAPTER 95,
 F. S. 195.3611 AS BY CERTIFIED BY:

ST. JOHNS COUNTY BOARD OF COUNTY COMMISSIONERS ST. JOHNS COUNTY CLERK OF COURTS

BOARD CHAIR CLERK

MAP SHOWING A SPECIFIC PURPOSE SURVEY OF

A PORTION OF CRACKER SWAMP ROAD:
 SECTIONS 33, 34, & 38 TOWNSHIP 9 SOUTH, RANGE 28 EAST,
 SECTIONS 3, 4, & 7 TOWNSHIP 10 SOUTH, RANGE 28 EAST,
 ST. JOHNS COUNTY, FLORIDA

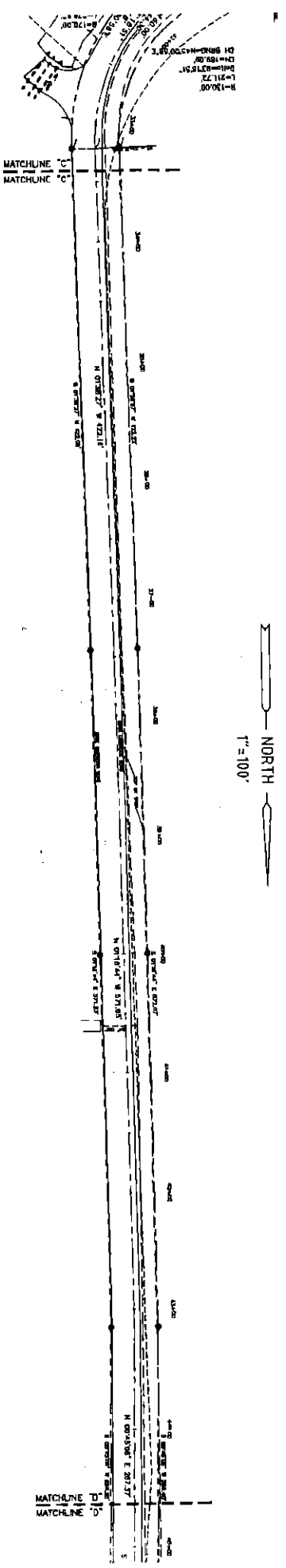

NORTH
 1" = 100'

TABLE OF ABBREVIATIONS

- | | | | |
|-----------------------------------|-----------------------------------|---|--|
| PT - POINT OF TANGENT | FP - FOUND ROUN PIPE | ● - BORN MARKER FOUND IDENTIFICATION AS NOTED | — CA — CENTRAL LINE |
| PCC - POINT OF COMPOUND CURVATURE | FRB - FOUND REBAR | ○ - 5/8" IRON SET P.S.M. 42161 | — B/L — BULKHEAD LINE |
| PC - POINT OF REVERSE CURVATURE | FRD - FOUND ROAD & DIRT | □ - CONCRETE MONUMENT FOUND IDENTIFICATION AS NOTED | — O/T — OVERHEAD TELEPHONE LINE |
| PI - PAVEMENT LINE | CSW - CONCRETE SIDEWALK | ▣ - 1 1/2" CONCRETE MONUMENT SET P.S.M. 41841 | — O/T — OVERHEAD TELEPHONE LINE |
| PL - PLANT | LP - LIGHT POLE | RP - RADIOS POINT | — B/E — BURIED ELECTRIC LINE |
| IC - CALCULATED | FP - FLAG POLE | R/W - RIGHT OF WAY | — B/T — BURIED TELEPHONE LINE |
| IR - IRREGULAR PERSPECTIVE | FI - FORCE MAIN FOR SEWER SERVICE | R/R - RAILROAD | — V — VENTILATES WATER LINE |
| IO - DEED | CO - CLEAN-OUT FOR SEWER SERVICE | R - RADIUS | — G — GAS LINE |
| (2) - ZONING | PP - POWER POLE | Δ - CENTRAL ANGLE | — FIVE LINE |
| PH - PERMANENT REFERENCE MONUMENT | QA - GUY WIRE & ANCHOR | ∠ - CHORD | DOT - DEPARTMENT OF TRANSPORTATION |
| PP - PERMANENT CONTROL POINT | UP - UTILITY POLE | ∩ - CHORD BEARING | USFELS - U.S. COAST & GEODETIC SURVEY |
| PC - FOUND CONCRETE MONUMENT | WH - WATER METER | L - ARC LENGTH | MOVT - OVERHILL ELEVATION |
| TR - TEMPORARY BENCH MARK | WV - WATER VALVE | PI - POINT OF INTERSECTION | O/R.V. - ORIGINAL RECORDS VOLUME AND PAGES |
| CP - CORRUGATED METAL PIPE | CP - CONCRETE PIPE | PC - POINT OF CURVATURE | FEL - FINISHED FLOOR ELEVATION |
| ⊕ - TEMPORARY BENCH MARK (TBM) | | | |

GENERAL NOTES:
 1. BEARINGS ARE BASED ON THE SOUTHERLY RIGHT-OF-WAY LINE OF COUNTY ROAD 13 AS BEING N89°16'00"W.
 2. THIS IS A SPECIFIC PURPOSE SURVEY ONLY AND DOES NOT PURPORT ANY JURISDICTION OF ANY FEDERAL, STATE, COUNTY OR LOCAL AGENCY. THE PURPOSE OF THIS SURVEY IS TO ESTABLISH THE MARKED RIGHT-OF-WAY OF RANCH ROAD.
 3. THIS SURVEY WAS PREPARED WITHOUT THE BENEFIT OF ABSTRACT OR TITLE COMMITMENT. THIS COMPANY BEARS NO RESPONSIBILITY TO ANY CLAIMS MADE BY SUCH INSTRUMENTS.
 4. THIS SURVEY IS NOT VALID WITHOUT THE SIGNATURE AND THE ORIGINAL RAISED SEAL OF A FLORIDA LICENSED SURVEYOR AND MAPPER.

I HEREBY CERTIFY that this map graphically depicts the results of a field survey made under my supervision, direction and control and that I am a duly Licensed Professional Surveyor and Mapper, Chapter 4817-6, Florida Administrative Code, pursuant to Section 472.021, Florida Statutes, subject to all notes and notations shown herein.

FIELD VERIFIED BY: REED DATE OF SIGNATURE: _____
 ALBERT O. BRADSHAW, P.S.M., F.S.M., F.S.M.A. (CERTIFICATION NO. 557)

PRIVETT-NILES and ASSOCIATES, INC.
 SURVEYING AND MAPPING CONSULTANTS
 LICENSED BUSINESS # 8824
 3000 N. PONCE DE LEON BOULEVARD, SUITE "D"
 ST. AUGUSTINE, FLORIDA 32085 (904) 829-2591

CRACKER SWAMP ROAD HAS BEEN VESTED IN THE COUNTY IN ACCORDANCE WITH CHAPTER 95,
F. S. 195.361 AS BY CERTIFIED BY:

ST. JOHNS COUNTY BOARD OF COUNTY COMMISSIONERS ST. JOHNS COUNTY CLERK OF COURTS

BOARD CHAIR

CLERK

MAP SHOWING A SPECIFIC PURPOSE SURVEY OF

A PORTION OF CRACKER SWAMP ROAD:
SECTIONS 33, 34, & 38 TOWNSHIP 9 SOUTH, RANGE 28 EAST,
SECTIONS 3, 4, & 37 TOWNSHIP 10 SOUTH, RANGE 28 EAST,
ST. JOHNS COUNTY, FLORIDA

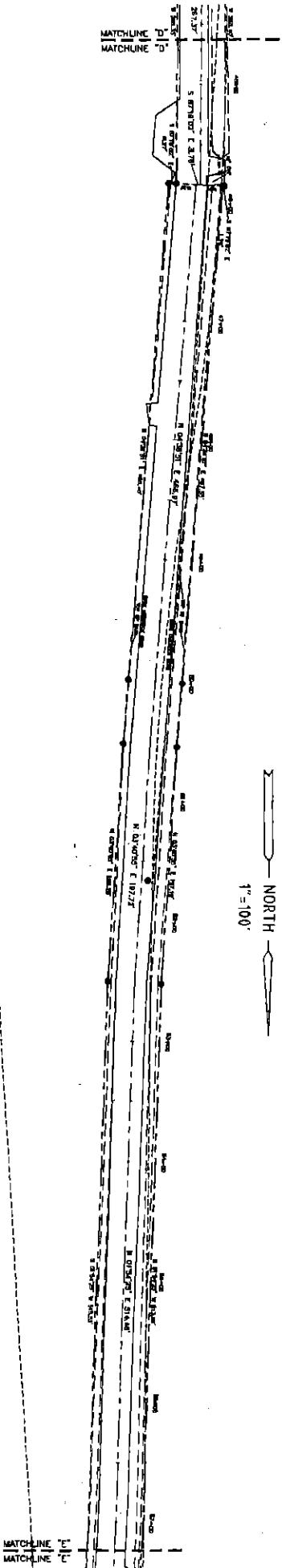

TABLE OF ABBREVIATIONS

PT - POINT OF TANGENCY	FP - FOUND FLOW PIPE	● - IRON MARKER FOUND IDENTIFICATION AS NOTED
PC - POINT OF COMPOUND CURVATURE	FRB - FOUND REBAR	○ - 5/8" REBAR SET P.S.M. #284
PRC - POINT OF REVERSE CURVATURE	FHD - FOUND HULL & DISC	■ - CONCRETE MONUMENT FOUND IDENTIFICATION AS NOTED
RI - RADIAL LINE	CSW - CONCRETE SIDEWALK	□ - 4" X 4" CONCRETE MONUMENT SET P.S.M. #284
PI - PLAT	LP - LIGHT POLE	RP - RADIOS POINT
IC - CALCULATED	FL - FLAG POLE	R/W - RIGHT OF WAY
MI - GROUND MEASUREMENT	FM - FORCE MAIN FOR SEWER SERVICE	R/R - RAILROAD
DI - DEED	CC - CLEAN-OUT FOR SEWER SERVICE	A - ANCHORS
IZ - ZONING	PP - POWER POLE	Δ - GEODAL ANGLE
PRM - PERMANENT REFERENCE MONUMENT	GAA - GUY WIRE & ANCHOR	C - CHORD BEARING
PCN - PERMANENT CONTROL POINT	UP - UTILITY POLE	I - IRON CORNER
FCM - FOUND CONCRETE MONUMENT	WH - WATER METER	PI - POINT OF INTERSECTION
TBM - TERRESTRIAL BENCH MARK	WV - WATER VALVE	PC - POINT OF CURVATURE
CPM - CORRODATED METAL PIPE	CP - CONCRETE PIPE	
⊕ - TERRESTRIAL BENCH MARK (TBM)		

GENERAL NOTES:
1. BEARINGS ARE BASED ON THE SOUTHERLY RIGHT-OF-WAY LINE OF COUNTY ROAD 13 AS BEING USED TODAY.

2. THIS IS A SPECIFIC PURPOSE SURVEY ONLY AND DOES NOT PURPORT ANY JURISDICTION OF ANY FEDERAL, STATE, COUNTY OR LOCAL AGENCY. THE PURPOSE OF THIS SURVEY IS TO ESTABLISH THE MAINTAINED RIGHT-OF-WAY OF RANCH ROAD.
3. THIS SURVEY WAS PREPARED WITHOUT THE BENEFIT OF ABSTRACT OR TITLE COMMITMENT. THIS COMPANY BEARS NO RESPONSIBILITY TO ANY CLAIMS MADE BY SUCH INSTRUMENTS.
4. THIS SURVEY IS PREPARED AND CERTIFIED FOR THE EXCLUSIVE USE OF THE CLIENT NAMED HEREON AND IS NOT VALID WITHOUT THE SIGNATURE AND THE ORIGINAL RAISED SEAL OF A FLORIDA LICENSED SURVEYOR AND MAPPER.

I HEREBY CERTIFY THAT I AM personally capable the results of a field survey made under my responsible direction and compliance with the latest Minimum Technical Standards for Surveys as promulgated by the Florida State Board of Professional Surveyors and Mappers, Chapter 60G17-6, Florida Administrative Code; Pursuant to Section 472.027, Florida Statutes; subject to all rules and regulations shown herein.

FIELD SURVEYOR
PRELIMINARY
OF SIGNATURE

ALBERT D. BRADSHAW, P.S.M., FLORIDA CERTIFICATION NO. 1537

PRIVETT-NILES and ASSOCIATES, INC.

SURVEYING AND MAPPING CONSULTANTS
LICENSED BUSINESS # 6924
3000 N. PONCE DE LEON BOULEVARD, SUITE "D"
ST. AUGUSTINE, FLORIDA 32085 (904) 829-2591

EXHIBIT "C" TO RESOLUTION

MEMORANDUM

TO: Mary Ann Blount – Real Estate
FROM: *FH* Frankie Hitchcock, - Road & Bridge Supervisor
DATE: April 10, 2001
SUBJECT: Cracker Swamp Road Maintenance



Speaking for the last 24 years it has been the County's responsibility to maintain Cracker Swamp Road. This includes digging ditches, road grading and stabilization. Approximately 1,000 loads of material have been used in the stabilization of this road.

Please call this office with any further questions you may have.