

RESOLUTION NO. 2004- 212

A RESOLUTION BY THE BOARD OF COUNTY COMMISSIONERS OF ST. JOHNS COUNTY, FLORIDA, ACCEPTING DRAINAGE EASEMENTS TO INSTALL CULVERTS, HEADWALLS AND GUARDRAILS ON COUNTY ROAD 13 AT THE INSECTIONS OF HUB BAILEY ROAD AND WHITE TOWER ROAD FOR THE IMPROVEMENTS TO THE DRAINAGE IN THIS AREA.

RECITALS

WHEREAS, the owners have executed and presented to the County Drainage Easements, attached hereto as Exhibits "A", "B", "C" and "D" incorporated by reference and made a part hereof; and

WHEREAS, the Drainage Easements are needed for installation and maintenance of the culverts, guardrails and headwalls to improve the drainage in this area; and

WHEREAS, it is in the best interest of the County to accept these Easements to ensure proper drainage for the health, safety, and welfare of the citizens in that area.

NOW, THEREFORE BE IT RESOLVED BY THE BOARD OF COUNTY COMMISSIONERS OF ST. JOHNS COUNTY, FLORIDA, as follows:

Section 1. The above recitals are incorporated by reference into the body of this Resolution and such recitals are adopted as findings of fact.

Section 2. The above-described Drainage Easements attached and incorporated hereto, are hereby accepted.

Section 3. The Clerk of the Circuit Court is instructed to record the original Drainage Easements in the Public Records of St. Johns County, Florida.

PASSED AND ADOPTED this 25 day of August, 2004.

BOARD OF COUNTY COMMISSIONERS
ST. JOHNS COUNTY, FLORIDA

By: 
Karen R. Stern Chair

ATTEST: Cheryl Strickland, Clerk

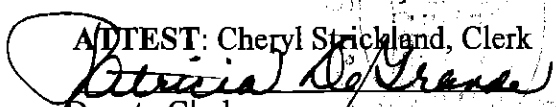
Deputy Clerk

RENDITION DATE 8-27-04

Exhibit "A" To Resolution

Prepared by:
St. Johns County
4020 Lewis Speedway
St. Augustine, Florida 32084

DRAINAGE EASEMENT

THIS GRANT OF EASEMENT, made this 13 day of July, 2004, between **ROBERT C. HARTWIG** whose address is 1310 Glen Laura Road Jacksonville, Florida 32205, hereinafter called Grantor, and **ST. JOHNS COUNTY, FLORIDA**, political subdivision of the State of Florida, whose address is 4020 Lewis Speedway, St. Augustine, Florida 32084, hereinafter called the Grantee.

WITNESSETH: That Grantor, for and in consideration of the sum of Ten Dollars (\$10.00) and other good and valuable consideration to them in hand paid by Grantee, the receipt of which is hereby acknowledged, has granted, bargained, sold, and conveyed to the Grantee, its successors and assigns forever, an unobstructed right of way and Drainage Easement with the right, privilege, and authority to said Grantee, its successors and assigns, the right to construct, lay, maintain, improve, and/or repair either above or below the surface of the ground, drainage facilities, on, along, over, through, across, or under the following described land situate in St. Johns County, Florida to wit:

As described on Exhibits "A" and "B" attached hereto, incorporated by reference and made a part hereof.

TOGETHER with the right of said Grantee, its successors and assigns, of ingress and egress to and over said above described premises, and for doing anything necessary or useful or convenient, or removing at any time any and all of said improvements upon, over, under, or in said lands, together also with the right and easement, privileges, and appurtenances in and to said land which may be required for the enjoyment of rights herein granted

EXHIBIT "A"
EASEMENT NO. 2

All that part of property described in deed recorded in Official Records Book 1346 page 1249, of the public records of St. Johns County, Florida, that lies within the following described parcel:

12 FOOT STRIP LOCATED AT THE SOUTHEAST QUADRANT OF COUNTY ROAD 13 SOUTH AND WHITE TOWER ROAD SAID STRIP BEING A PART OF SECTION 28, TOWNSHIP 9 SOUTH, RANGE 28 EAST, ST. JOHNS COUNTY, FLORIDA BEING MORE PARTICULARLY DESCRIBED AS FOLLOWS: STRIP IS BOUNDED ON THE EAST BY A LINE PERPENDICULAR TO CENTERLINE OF RIGHT OF WAY STATION 632+22 AS SHOWN ON CR 13 CULVERT IMPROVEMENTS ENGINEERING PLANS PREPARED BY JONES EDMUNDS & ASSOCIATES, INC. DATED 09-15-2003; BOUNDED ON THE NORTH BY THE EXISTING SOUTHERLY RIGHT OF WAY LINE OF CR 13 AS SHOWN ON SAID ENGINEERING PLANS; BOUNDED ON THE WEST BY THE EASTERLY RIGHT OF LINE OF WHITE TOWER ROAD; AND BOUNDED ON THE SOUTH BY A LINE PARALLEL WITH AND 12 FEET SOUTHERLY OF AFOREMENTIONED EXISTING SOUTHERLY RIGHT OF WAY LINE OF CR13.

IN WITNESS WHEREOF, Grantor has hereunto set hand and seal the day and year first above written.

Signed and Sealed in Our Presence as Witnesses:

Shirley Taylor
Witness

Robert C. Hartwig
Robert C. Hartwig

Dea Felto
Witness

STATE OF FLORIDA
COUNTY OF Deval

The foregoing instrument was acknowledged before me this 13 day of July, 2004, by Robert C. Hartwig.
He is personally known to me or has produced as identification.

Julie Bounds
Notary Public
NOTARY PUBLIC, STATE OF FLORIDA
COMMISSION NO. DD 099704
MY COMMISSION EXPIRES MARCH 13, 2006

**TOTAL IMPACTED ACREAGE FOR THIS
CULVERT MODIFICATION PROJECT
SITE: 0.06 ACRES (2,484 S.F.)**

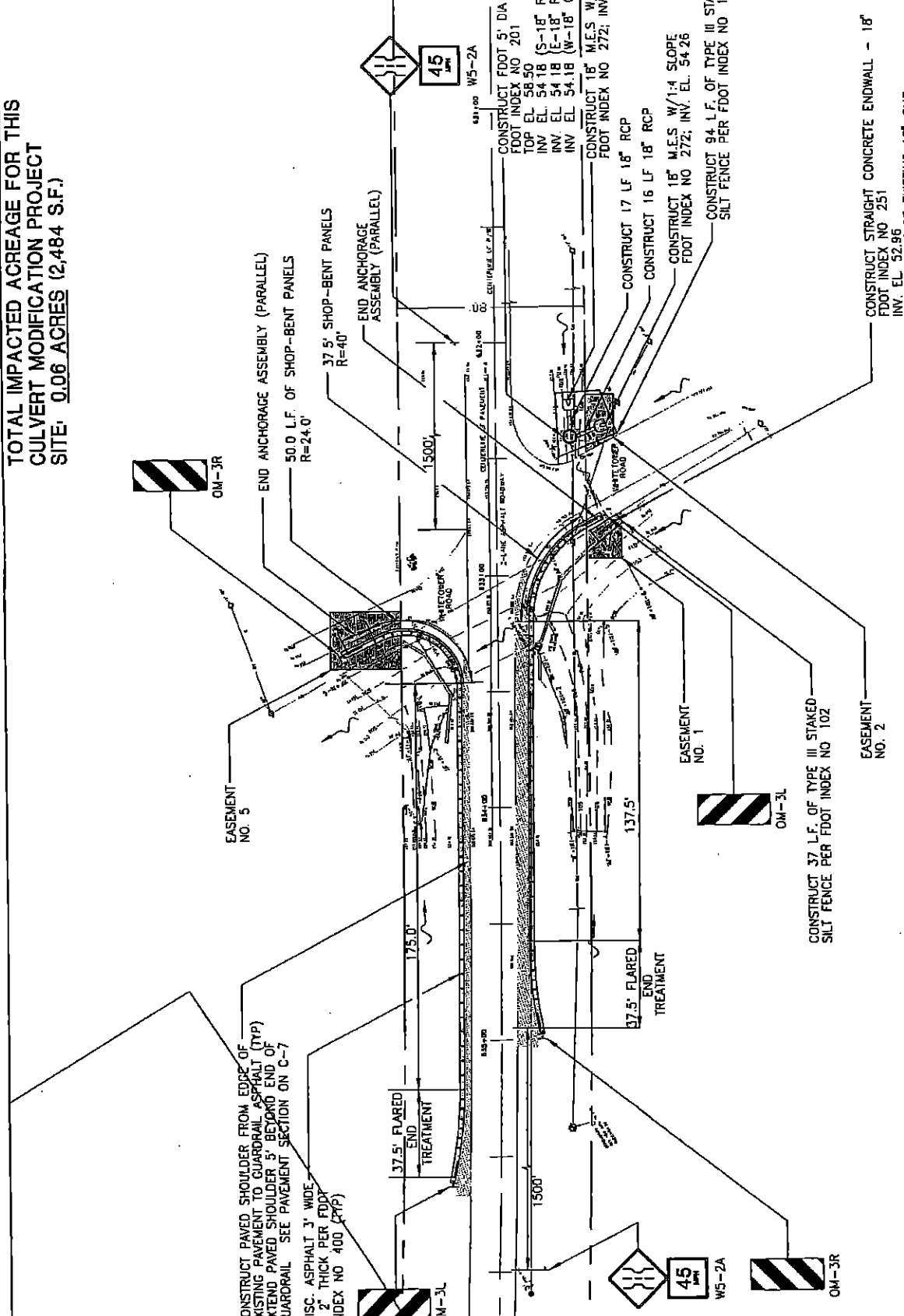
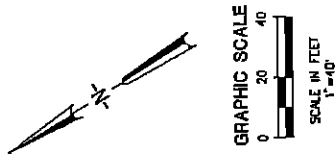

CONSTRUCT STRAIGHT CONCRETE ENDWALL - 18'
FOOT INDEX NO 251
INV. EL. 52.96
REMOVE 4' LF OF EXISTING 18" CMP.

CULVERT AT MILEMARKER 5.5
PAST FLAGLER ESTATES

CR 18 CULVERT IMPROVEMENTS
ST. JOHNS COUNTY, FLORIDA

*Jones
Engineering
Associates, Inc. JEA*

DESIGNED BY: K. FALGOUTER
CHECKED BY: J. WELLS
PROJECT ENGINEER: KAREN FALGOUTER, P.E.

DATE	BY	REVISIONS
06/01/03	JEA	100% SUBMITTAL
05/24/03	JEA	80% SUBMITTAL

100% SUBMITTAL

DATE	02-15-2003	PROJECT NO.	19270-015-01
SCALE	1"=40'	DRAWN BY	KAREN FALGOUTER, P.E.
		CHECKED BY	J. WELLS
		DATE	02-18

Exhibit #

EXHIBIT "B" TO RESOLUTION

Prepared by:
St. Johns County
4020 Lewis Speedway
St. Augustine, Florida 32084

DRAINAGE EASEMENT

THIS GRANT OF EASEMENT, made this 13 day of July, 2004, between **H. WESLEY SMITH AS TRUSTEE OF THE H. WESLEY SMITH REVOCABLE LIVING TRUST DATED SEPTEMBER 7, 2000, AND AMENDED DECEMBER 20, 2001**, whose address is 8770 CR 13 South Hastings, Florida 32145, hereinafter called Grantor, and **ST. JOHNS COUNTY, FLORIDA**, political subdivision of the State of Florida, whose address is 4020 Lewis Speedway, St. Augustine, Florida 32084, hereinafter called the Grantee.

WITNESSETH: That Grantor, for and in consideration of the sum of Ten Dollars (\$10.00) and other good and valuable consideration to them in hand paid by Grantee, the receipt of which is hereby acknowledged, has granted, bargained, sold, and conveyed to the Grantee, its successors and assigns forever, an unobstructed right of way and Drainage Easement with the right, privilege, and authority to said Grantee, its successors and assigns, the right to construct, lay, maintain, improve, and/or repair either above or below the surface of the ground, drainage facilities, on, along, over, through, across, or under the following described land situate in St. Johns County, Florida to wit:

As described on Exhibits "A" and "B" attached hereto, incorporated by reference and made a part hereof.

TOGETHER with the right of said Grantee, its successors and assigns, of ingress and egress to and over said above described premises, and for doing anything necessary or useful or convenient, or removing at any time any and all of said improvements upon, over, under, or in said lands, together also with the right and easement, privileges, and appurtenances in and to said land which may be required for the enjoyment of rights herein granted

IN WITNESS WHEREOF, Grantor has hereunto set hand and seal the day and year first above written.

Signed and Sealed in Our
Presence as Witnesses:

Karen Brothe
Witness

H. Wesley Smith
H. WESLEY SMITH
Trustee

Keith E. Cutler
Witness

STATE OF FLORIDA
COUNTY OF St. Johns

The foregoing instrument was acknowledged before me this 13th day of July, 2004, by H. Wesley Smith who is personally known to me or has produced _____ as identification.

Keith E. Cutler
Notary Public



Keith E. Cutler
MY COMMISSION # DD100262 EXPIRES
April 13, 2006
BONDED THRU TROY FAIN INSURANCE, INC

EXHIBIT "A"
EASEMENT NO. 3

All that part of property described in deed recorded in Official Records Book 2167 page 147, of the public records of St. Johns County, Florida, that lies within the following described parcel:

15 FOOT STRIP LOCATED NEAR THE SOUTHWEST QUADRANT OF COUNTY ROAD 13 SOUTH AND REID PACKING HOUSE ROAD SAID STRIP BEING A PART OF SECTION 28, TOWNSHIP 9 SOUTH, RANGE 28 EAST, ST. JOHNS COUNTY, FLORIDA BEING MORE PARTICULARLY DESCRIBED AS FOLLOWS: STRIP IS BOUNDED ON THE EAST BY A LINE PERPENDICULAR TO CENTERLINE OF RIGHT OF WAY STATION 578+65 AS SHOWN ON CR 13 CULVERT IMPROVEMENTS ENGINEERING PLANS PREPARED BY JONES EDMUNDS & ASSOCIATES, INC. DATED 09-15-2003; BOUNDED ON THE NORTH BY THE EXISTING SOUTHERLY RIGHT OF WAY LINE OF CR 13 AS SHOWN ON SAID ENGINEERING PLANS; BOUNDED ON THE WEST BY A LINE PERPENDICULAR TO CENTERLINE OF RIGHT OF WAY STATION 579+00 AS SHOWN ON AFOREMENTIONED ENGINEERING PLANS; AND BOUNDED ON THE SOUTH BY A LINE PARALLEL WITH AND 15 FEET SOUTHERLY OF AFOREMENTIONED EXISTING SOUTHERLY RIGHT OF WAY LINE OF CR13.

EXHIBIT "C" TO RESOLUTION

Prepared by:
St. Johns County
4020 Lewis Speedway
St. Augustine, Florida 32084

DRAINAGE EASEMENT

THIS GRANT OF EASEMENT, made this 15th day of July, 2004, between **HASTINGS DRAINAGE DISTRICT**, an independent special district, whose address is P.O. Box 561, Hastings, Florida 32145, hereinafter called Grantor, and **ST. JOHNS COUNTY, FLORIDA**, political subdivision of the State of Florida, whose address is 4020 Lewis Speedway, St. Augustine, Florida 32084, hereinafter called the Grantee.

WITNESSETH: That Grantor, for and in consideration of the sum of Ten Dollars (\$10.00) and other good and valuable consideration to them in hand paid by Grantee, the receipt of which is hereby acknowledged, has granted, bargained, sold, and conveyed to the Grantee, its successors and assigns forever, an unobstructed right of way and Drainage Easement with the right, privilege, and authority to said Grantee, its successors and assigns, the right to construct, lay, maintain, improve, and/or repair either above or below the surface of the ground, drainage facilities, on, along, over, through, across, or under the following described land situate in St. Johns County, Florida to wit:

As described on Exhibits "A" and "B" attached hereto, incorporated by reference and made a part hereof.

TOGETHER with the right of said Grantee, its successors and assigns, of ingress and egress to and over said above described premises, and for doing anything necessary or useful or convenient, or removing at any time any and all of said improvements upon, over, under, or in said lands, together also with the right and easement, privileges, and appurtenances in and to said land which may be required for the enjoyment of rights herein granted

IN WITNESS WHEREOF, Grantor has hereunto set hand and seal the day and year first above written.

Signed and Sealed in Our Presence as Witnesses:

Hastings Drainage District

Elaine M Hart

Witness

By: Frank C Johns Jr
Frank C. Johns Jr.
Its: Chairman

Amam B... ..
Witness

STATE OF FLORIDA
COUNTY OF _____

The foregoing instrument was acknowledged before me this 15th day of July, 2004, by Frank C Johns Jr.
He is personally known to me or has produced _____ as identification.

Elaine M Hart
Notary Public

ELAINE M. HART
Notary Public, State of Florida
My comm. exp. June 17, 2005
Comm. No. DD 031592

EXHIBIT "A"

EASEMENT NO. 1

ALL THAT PART OF PROPERTY DESCRIBED IN DEED RECORDED IN DEED BOOK 43, PAGE 269, OF THE PUBLIC RECORDS OF ST. JOHNS COUNTY, FLORIDA, BEING PART OF CANAL NO. 1, THAT LIES WITHIN THE FOLLOWING DESCRIBED PARCEL:

15 FOOT STRIP LOCATED AT THE SOUTHWEST QUADRANT OF COUNTY ROAD 13 SOUTH AND WHITE TOWER ROAD SAID STRIP BEING A PART OF SECTION 29, TOWNSHIP 9 SOUTH, RANGE 28 EAST, ST. JOHNS COUNTY, FLORIDA BEING MORE PARTICULARLY DESCRIBED AS FOLLOWS: STRIP IS BOUNDED ON THE WEST BY A LINE PERPENDICULAR TO CENTERLINE OF RIGHT OF WAY STATION 632+93 AS SHOWN ON CR 13 CULVERT IMPROVEMENTS ENGINEERING PLANS PREPARED BY JONES EDMUNDS & ASSOCIATES, INC. DATED 09-15-2003; BOUNDED ON THE NORTH BY THE EXISTING SOUTHERLY RIGHT OF WAY LINE OF CR 13 AS SHOWN ON SAID ENGINEERING PLANS; BOUNDED ON THE EAST BY THE WESTERLY RIGHT OF WAY LINE OF WHITE TOWER ROAD; AND BOUNDED ON THE SOUTH BY A LINE PARALLEL WITH AND 15 FEET SOUTHERLY OF AFOREMENTIONED EXISTING SOUTHERLY RIGHT OF WAY LINE OF CR13.

EASEMENT NO. 3

ALL THAT PART OF PROPERTY DESCRIBED IN DEEDS RECORDED IN DEED BOOK 44, PAGE 139 AND DEED BOOK 44, PAGE 140, OF THE PUBLIC RECORDS OF ST. JOHNS COUNTY, FLORIDA, BEING PART OF CANAL NO. 4, THAT LIES WITHIN THE FOLLOWING DESCRIBED PARCEL:

15 FOOT STRIP LOCATED NEAR THE SOUTHWEST QUADRANT OF COUNTY ROAD 13 SOUTH AND REID PACKING HOUSE ROAD SAID STRIP BEING A PART OF SECTION 28, TOWNSHIP 9 SOUTH, RANGE 28 EAST, ST. JOHNS COUNTY, FLORIDA BEING MORE PARTICULARLY DESCRIBED AS FOLLOWS: STRIP IS BOUNDED ON THE EAST BY A LINE PERPENDICULAR TO CENTERLINE OF RIGHT OF WAY STATION 578+65 AS SHOWN ON CR 13 CULVERT IMPROVEMENTS ENGINEERING PLANS PREPARED BY JONES EDMUNDS & ASSOCIATES, INC. DATED 09-15-2003; BOUNDED ON THE NORTH BY THE EXISTING SOUTHERLY RIGHT OF WAY LINE OF CR 13 AS SHOWN ON SAID ENGINEERING PLANS; BOUNDED ON THE WEST BY A LINE PERPENDICULAR TO CENTERLINE OF RIGHT OF WAY STATION 579+00 AS SHOWN ON AFOREMENTIONED ENGINEERING PLANS; AND BOUNDED ON THE SOUTH BY A LINE PARALLEL WITH AND 15 FEET SOUTHERLY OF AFOREMENTIONED EXISTING SOUTHERLY RIGHT OF WAY LINE OF CR13.

EASEMENT NO. 4

ALL THAT PART OF PROPERTY DESCRIBED IN DEED RECORDED IN DEED BOOK 44, PAGE 139, OF THE PUBLIC RECORDS OF ST. JOHNS COUNTY, FLORIDA, BEING PART OF CANAL NO. 4, THAT LIES WITHIN THE FOLLOWING DESCRIBED PARCEL:

15 FOOT STRIP LOCATED AT THE NORTHEAST QUADRANT OF COUNTY ROAD 13 SOUTH AND HUB BAILEY ROAD SAID STRIP BEING A PART OF SECTION 28, TOWNSHIP 9 SOUTH, RANGE 28 EAST, ST. JOHNS COUNTY, FLORIDA BEING MORE PARTICULARLY DESCRIBED AS FOLLOWS: STRIP IS BOUNDED ON THE EAST BY A LINE PERPENDICULAR TO CENTERLINE OF RIGHT OF WAY STATION 578+00 AS SHOWN ON CR 13 CULVERT IMPROVEMENTS ENGINEERING PLANS PREPARED BY JONES EDMUNDS & ASSOCIATES, INC. DATED 09-15-2003; BOUNDED ON THE SOUTH BY THE EXISTING NORTHERLY RIGHT OF WAY LINE OF CR 13 AS SHOWN ON SAID ENGINEERING PLANS; BOUNDED ON THE WEST BY A LINE PERPENDICULAR TO CENTERLINE OF RIGHT OF WAY STATION 578+22 AS SHOWN ON AFOREMENTIONED ENGINEERING PLANS; AND BOUNDED ON THE NORTH BY A LINE PARALLEL WITH AND 15 FEET NORTHERLY OF AFOREMENTIONED EXISTING NORTHERLY RIGHT OF WAY LINE OF CR13.

EASEMENT NO. 5

ALL THAT PART OF HASTINGS DRAINAGE CANAL NO. 1 IN SECTION 20, TOWNSHIP 9 SOUTH, RANGE 28 EAST, ST. JOHNS COUNTY, FLORIDA, THAT LIES WITHIN THE FOLLOWING DESCRIBED PARCEL:

30 FOOT STRIP LOCATED AT THE NORTHWEST QUADRANT OF COUNTY ROAD 13 SOUTH AND WHITE TOWER ROAD SAID STRIP BEING A PART OF SECTIONS 20 AND 21, TOWNSHIP 9 SOUTH, RANGE 28 EAST, ST. JOHNS COUNTY, FLORIDA BEING MORE PARTICULARLY DESCRIBED AS FOLLOWS: STRIP IS BOUNDED ON THE WEST BY A LINE PERPENDICULAR TO CENTERLINE OF RIGHT OF WAY STATION 633+40 AS SHOWN ON CR 13 CULVERT IMPROVEMENTS ENGINEERING PLANS PREPARED BY JONES EDMUNDS & ASSOCIATES, INC. DATED 09-15-2003; BOUNDED ON THE SOUTH BY THE EXISTING NORTHERLY RIGHT OF WAY LINE OF CR 13 AS SHOWN ON SAID ENGINEERING PLANS; BOUNDED ON THE EAST BY A LINE PERPENDICULAR TO CENTERLINE OF RIGHT OF WAY STATION 633+15 AS SHOWN ON CR 13 CULVERT IMPROVEMENTS ENGINEERING PLANS PREPARED BY JONES EDMUNDS & ASSOCIATES, INC. DATED 09-15-2003; AND BOUNDED ON THE NORTH BY A LINE PARALLEL WITH AND 30 FEET NORTHERLY OF AFOREMENTIONED EXISTING NORTHERLY RIGHT OF WAY LINE OF CR13.

EXHIBIT "B"

TOTAL IMPACTED ACREAGE FOR THIS
CULVERT MODIFICATION PROJECT
SITE: 0.06 ACRES (2,484 S.F.)

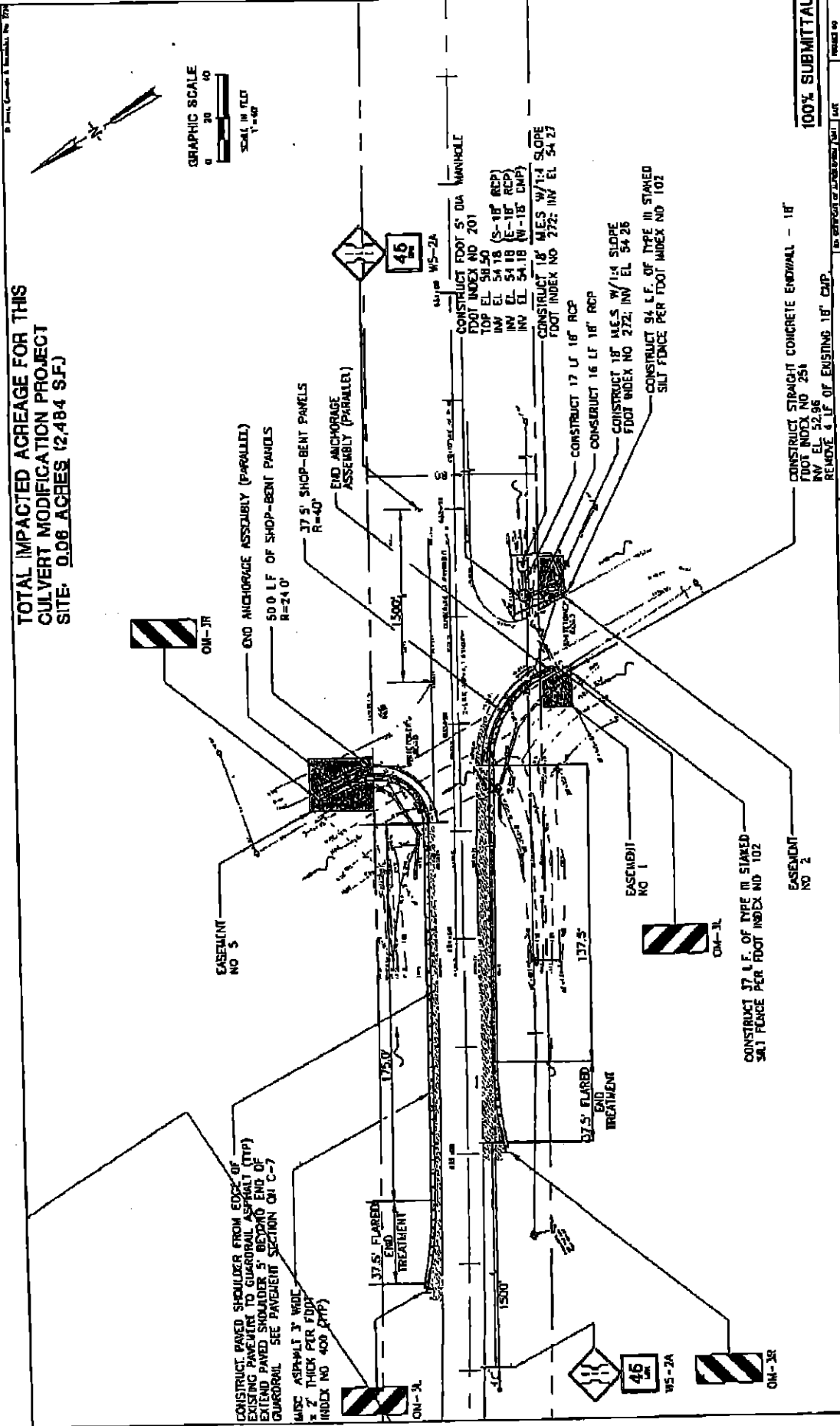

100% SUBMITTAL

DATE	PROJECT NO.
09-15-2003	1620-01a-un
SCALE	DATE
1"=40'	06-18
DESIGNED BY	CHECKED BY
MARK J. GARDNER, P.E.	MARK J. GARDNER, P.E.
PROJECT NO.	DATE
1620-01a-un	06-18

CONSTRUCT STRAIGHT CONCRETE ENDWALL - 18'
FOOT INDEX NO 251
INV EL. 52.96
REMOVE 4 LF OF EXISTING 18' CMP.

CULVERT AT MILEMARKER 5.6
PAST FLAGLER ESTATES

CR IS CULVERT IMPROVEMENTS
ST. JOHNS COUNTY, FLORIDA

Mark J. Gardner
Professional Engineer
No. 12345
Mark J. Gardner, P.E.
Mark J. Gardner, P.E.

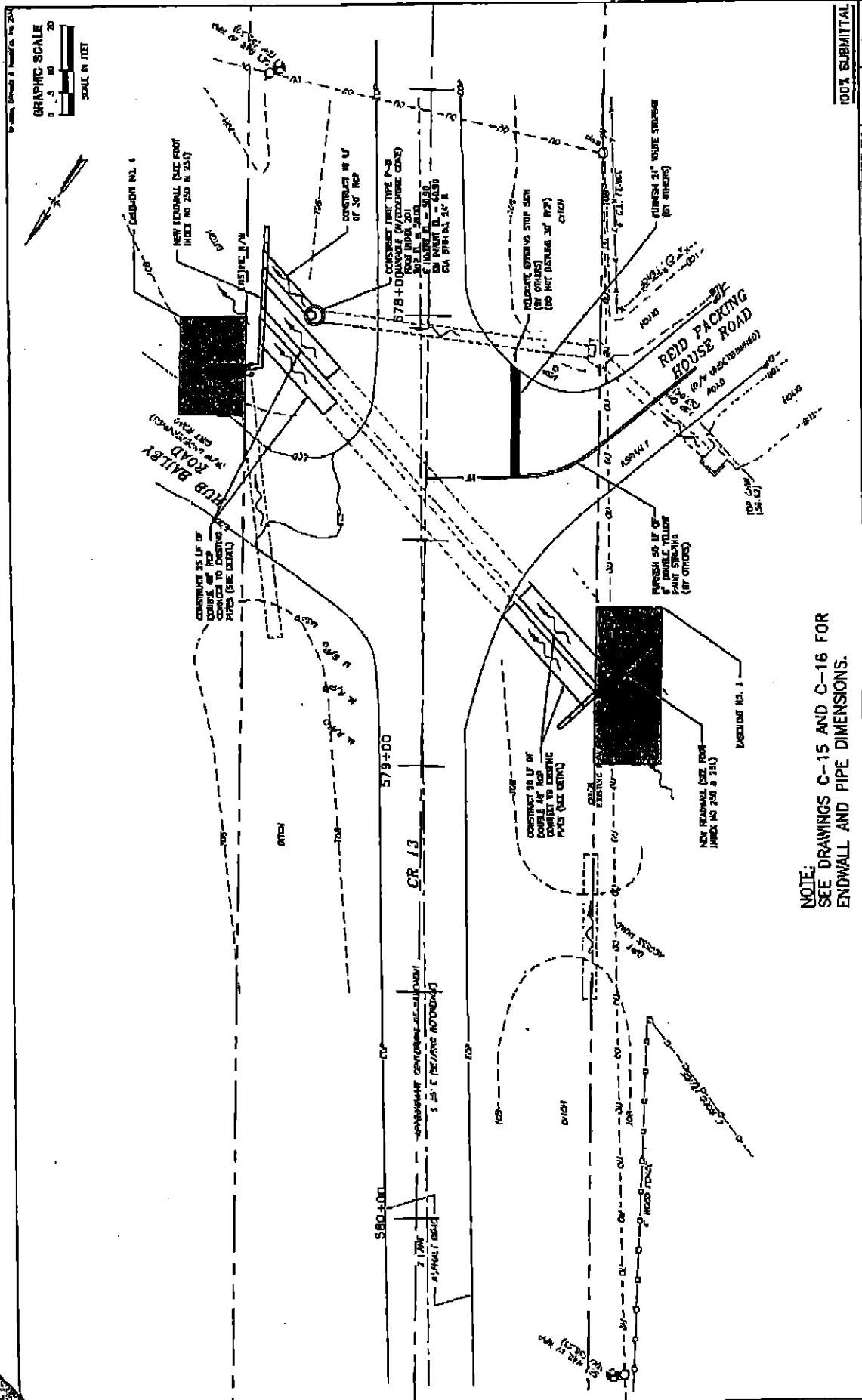

NOTE:
SEE DRAWINGS C-15 AND C-16 FOR
ENDWALL AND PIPE DIMENSIONS.

100% SUBMITTAL	
DATE	1/14/00
PROJECT NO.	15079-015-07
APPROVED FOR BY	
DATE	
SCALE	AS SHOWN
BY	W. L. HANSEN, P.E.
CHECKED BY	P. J. JONES
DATE	6-11
SITE PLAN CULVERT AT MILE-MARKER 4.5	
CR 13 CULVERT MODIFICATIONS ST. JOHNS COUNTY, FLORIDA	
J. Jones P. J. Jones W. L. Hansen Associates, Inc. JEA 1700 S. W. 10th St. Ft. Lauderdale, FL 33304 Phone: (954) 533-1111 Fax: (954) 533-1112	

EXHIBIT "D" TO RESOLUTION

Prepared by:
St. Johns County
4020 Lewis Speedway
St. Augustine, Florida 32084

DRAINAGE EASEMENT

THIS GRANT OF EASEMENT, made this ____ day of _____, 2004, between **FPI ENTERPRISES LLC**, a Florida limited liability company whose address is 6245 County Road 13 South, Hastings, Florida 32145, hereinafter called Grantor, and **ST. JOHNS COUNTY, FLORIDA**, political subdivision of the State of Florida, whose address is 4020 Lewis Speedway, St. Augustine, Florida 32084, hereinafter called the Grantee.

WITNESSETH: That Grantor, for and in consideration of the sum of Ten Dollars (\$10.00) and other good and valuable consideration to them in hand paid by Grantee, the receipt of which is hereby acknowledged, has granted, bargained, sold, and conveyed to the Grantee, its successors and assigns forever, an unobstructed right of way and Drainage Easement with the right, privilege, and authority to said Grantee, its successors and assigns, the right to construct, lay, maintain, improve, and/or repair either above or below the surface of the ground, drainage facilities, on, along, over, through, across, or under the following described land situate in St. Johns County, Florida to wit:

As described on Exhibits "A" and "B" attached hereto, incorporated by reference and made a part hereof.

TOGETHER with the right of said Grantee, its successors and assigns, of ingress and egress to and over said above described premises, and for doing anything necessary or useful or convenient, or removing at any time any and all of said improvements upon, over, under, or in said lands, together also with the right and easement, privileges, and appurtenances in and to said land which may be required for the enjoyment of rights herein granted.

EXHIBIT "A"
EASEMENT NO. 5

All that part of property described in deed recorded in Official Records Book 2098, page 707, of the public records of St. Johns County, Florida, that lies within the following described parcel:

30 FOOT STRIP LOCATED AT THE NORTHWEST QUADRANT OF COUNTY ROAD 13 SOUTH AND WHITE TOWER ROAD SAID STRIP BEING A PART OF SECTIONS 20 AND 21, TOWNSHIP 9 SOUTH, RANGE 28 EAST, ST. JOHNS COUNTY, FLORIDA BEING MORE PARTICULARLY DESCRIBED AS FOLLOWS: STRIP IS BOUNDED ON THE WEST BY A LINE PERPENDICULAR TO CENTERLINE OF RIGHT OF WAY STATION 633+40 AS SHOWN ON CR 13 CULVERT IMPROVEMENTS ENGINEERING PLANS PREPARED BY JONES EDMUNDS & ASSOCIATES, INC. DATED 09-15-2003; BOUNDED ON THE SOUTH BY THE EXISTING NORTHERLY RIGHT OF WAY LINE OF CR 13 AS SHOWN ON SAID ENGINEERING PLANS; BOUNDED ON THE EAST BY A LINE PERPENDICULAR TO CENTERLINE OF RIGHT OF WAY STATION 633+15 AS SHOWN ON CR 13 CULVERT IMPROVEMENTS ENGINEERING PLANS PREPARED BY JONES EDMUNDS & ASSOCIATES, INC. DATED 09-15-2003; AND BOUNDED ON THE NORTH BY A LINE PARALLEL WITH AND 30 FEET NORTHERLY OF AFOREMENTIONED EXISTING NORTHERLY RIGHT OF WAY LINE OF CR13.

IN WITNESS WHEREOF, Grantor has hereunto set hand and seal the day and year first above written.

Signed and Sealed in Our Presence as Witnesses:

Debbie Taylor
Witness
Frank C. Johns
Witness

FPJ Enterprises, LLC
A Florida limited liability company
By: Frank C. Johns
Its managing member

STATE OF FLORIDA St. Johns
COUNTY OF

The foregoing instrument was acknowledged before me this 23rd day of July, 2004, by Frank C. Johns as Managing Member the managing member of FPJ Enterprises, LLC. Who is personally known to me or has produced _____ as identification.

Debbie Taylor
Notary Public

