

RESOLUTION NO. 2013- 230

**A RESOLUTION BY THE BOARD OF COUNTY COMMISSIONERS OF ST. JOHNS COUNTY, FLORIDA, APPROVING THE TERMS AND AUTHORIZING THE COUNTY ADMINISTRATOR, OR DESIGNEE, TO SUBMIT A LONG RANGE BEACH EROSION CONTROL BUDGET PLAN WITH THE DEPARTMENT OF ENVIRONMENTAL PROTECTION, BUREAU OF BEACHES AND COASTAL SYSTEMS.**

**WHEREAS**, St. Johns County is currently working with the Army Corps of Engineers and FDEP on the St. Augustine Beach erosion control monitoring and maintenance of the constructed project and design of the next nourishment for the portion of beaches between ACOE markers R-137 and R-151; and,

**WHEREAS**, the Army Corps of Engineers (ACOE) is expected to appropriate funds for this project in the next fiscal year; and,

**WHEREAS**, St. Johns County also anticipates sharing costs with the State of Florida under a State DEP Beaches and Coastal Systems grant; and,

**WHEREAS**, the State Department of Environmental Protection has begun a new grant cycle which will require submitting an annual application along with a ten-year budget plan; and,

**WHEREAS**, St. Johns County will continue to provide local cost share funding from the Category III Tourist Development Tax Budget, and

**WHEREAS**, St. Johns County will continue to serve as the local sponsor; and,

**WHEREAS**, the Florida Department of Environmental Protection Bureau of Beaches and Coastal Systems requires an annual contract for its local share, contingent upon annual appropriations by the legislature.

**NOW, THEREFORE, BE IT RESOLVED BY THE BOARD OF COUNTY COMMISSIONERS OF ST. JOHNS COUNTY, FLORIDA, AS FOLLOWS:**

Section (1). The above Recitals are incorporated by reference into the body of this Resolution and such Recitals are adopted as findings of fact.

Section (2). That a suggested 10-year budget plan for funding the State's portion of a beach nourishment project for the St. Augustine Beaches project be filed with the Florida Department of Environmental Protection, Bureau of Beaches and Coastal Systems (the "Department"), and

Section (3). That the County Administrator, or designee, is hereby authorized to submit a proposed 10-year State budget plan to the Department and to execute any necessary agreements concerning the beach projects with the Department; and,

Section (4). That the County Administrator's, or designee's, submission of any budget plan is subject to, and contingent upon, an annual budget appropriation by the Board of County Commissioners.

Section (5). To the extent that there are typographical and/or administrative errors and/or omissions that do not change the tone, tenor, or content of this Resolution, then this Resolution may be revised without subsequent approval of the Board of County Commissioners.

**PASSED AND ADOPTED** by the Board of County Commissioners of St. Johns County, State of Florida, this 15<sup>th</sup> day of October, 2013.

**BOARD OF COUNTY COMMISSIONERS OF  
ST. JOHNS COUNTY, FLORIDA**

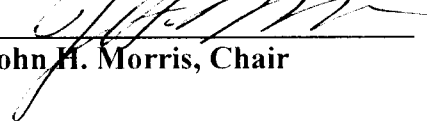
By:   
**John H. Morris, Chair**

ATTEST: Cheryl Strickland, Clerk

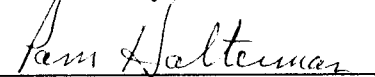
By:   
**Deputy Clerk**

RENDITION DATE 10/17/13

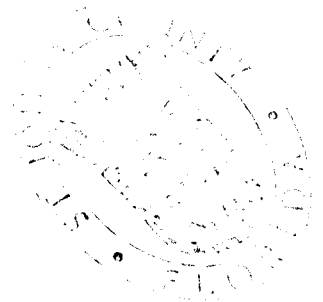

## FY 2014-15 Local Government Funding Request

**Project Name (Same as previous phase):** St. Johns County Shore Protection Program; St. Johns County R-137 through R-151

**Project Description: (Should be consistent year to year with annual updates. Include county, location with reference to range monuments, brief project history and upcoming beach activities.)** The project consists of a multi-year federal commitment to design, construct and monitor beach restoration of the severely eroded beaches of Anastasia State Park and St. Augustine Beach. The scope focuses on the FDEP-designated critical erosion areas between R137 and R151 at the center of the County and just South of the St Augustine Inlet. The project is part of 50 year commitment to the US Army Corps of Engineers to renourish this segment of Beach Construction (beach nourishment). The third phase of sand placement is complete and first year monitoring is underway for the St. Johns Shore Protection Project.

The initial nourishment (referred to as the 2003 project) of the St. Johns County SPP, completed in January 2003, extended 2.9 mi from approximately 600 feet (ft) north of FDEP monument R-137A (2.7 mi south of St. Augustine Inlet in Anastasia State Park) south to approximately 600 ft south of FDEP monument R-151 in the City of St. Augustine Beach in St. Johns County, Florida (Figure 2.1). The state of Florida, piggybacking the federal nourishment project, extended the beach nourishment project approximately 0.9 mi north into Anastasia State Park to FDEP monument T-132.

The 2003 project construction occurred as follows. The initial nourishment of the St. Johns County SPP began in 2001 before funding difficulties interrupted construction. Between September and October 2001, the USACE placed sand approximately 1.1 mi from R-145 south to R-151 on St. Augustine Beach. Project construction resumed in April 2002 and finished in January 2003. The project extended from the state portion's northern limit at T-132 to the federal portion's southern limit at R-151.

The first Renourishment (referred to as the 2005 project) extended approximately 2.9 mi from Monuments R-137A to R-151. The 2004 hurricane season resulted in the need to renourish the project before the anticipated nourishment interval. Congress appropriated emergency funds in response to the storms. Taylor Engineering applied for and received from the FDEP a one year extension to the existing five year, 2003 FDEP permit. Construction began in June and concluded in December 2005. The two projects have placed approximately 7 million cubic yards (mcy) on St. Augustine beach. Table 2.1 documents the nourishment history.

For both the 2003 and 2005 projects, a portion of the St. Augustine Inlet ebb shoal (Figure 2.1) served as the borrow area. Figure 2.1 illustrates the 2005 borrow area limits and the location of the 2005 project beach fill placement and control areas. Note that the 2003 borrow area encompassed a larger footprint by including the 2005 borrow area and extending into the northern lobe of the St. Augustine Inlet ebb shoal (Taylor Engineering, 2004). The monitoring data document the effects of the combined nourishment projects on the fill placement area, the north control area, the south control area, Vilano Beach, and the borrow area.

**Use of Requested Program Funds:** Funds requested for FY2014–15 will support the monitoring phase of the current nourishment cycle of the project. The budgets requested include the State share for continued monitoring of the recently reconstructed beach project.

**Federal Funding:** The USACE 1998 General Reevaluation Report (GRR) constitutes the authorization document for this project. The US congress and Senate granted \$7,000,000 to this project to fund Design and construction of the storm related damage caused by T.S. Faye during the FY 2009-2010 period. The US Congress and Senate secured an additional \$350,000 for construction during the FY 2010-2011 legislation. The US Presidents Budget has secured an additional \$6,350,000 in appropriations for the Shore Protection Project for FY2011. Overall the project has secured \$13.8M in Federal Funding for this nourishment cycle.

**Local Commitment:** The County has executed a project cost sharing agreement with the USACE for the 50-year project life. St. Johns County has funded the USACE for the design of the 2010 re-nourishment effort based on the Federal Funding cost share and continues to retain the services of the coastal engineering firm Taylor Engineering, Inc. to assist in project management, tracking, monitoring, and assistance with design and permitting and other related future activities. St. Johns County is obtaining local funding for the project from the Tourist Development Council, which provides a dedicated and scheduled funding source. The county includes funds necessary to construct and maintain the project in the county's capital improvement plan.

On recent projects, St. Johns County government has exhibited its professional capabilities to administer large-scale beach nourishment and shore protection projects.

With this funding request, St. Johns County has included a proposed resolution that states its support of the proposed project, willingness to serve as the local sponsor, and ability to provide the local cost share. The St. Johns County BCC will consider this resolution in October 2013. St. Johns County will furnish a copy of the approved resolution to the FDEP.

**State Commitment:** The state appropriated \$91,773 for project monitoring, beach tilling, and scarp removal in FY 2013-2014 as its cost share on an anticipated \$118,909 local sponsor commitment. Continuation of this federal project relies on the annual commitment from the FDEP and St. Johns County (local sponsor). The FDEP recommends the project in its draft Strategic Beach Management Plan for St. Johns County beaches. In addition, the project areas lie within FDEP-designated critical erosion areas.

**Local Government Support**

Does this sponsor have dedicated support staff whose sole priority is to manage beach erosion control activities? No

Name	Title	Email	Percent Commitment
<b>Address 1:</b>		<b>Phone:</b>	
<b>Address 2:</b>		<b>Fax:</b>	

**Quarterly Report Compliance:**

2013-2014	End Date	Report Sent	Compliant
Qtr 1 (Sept)	9/30/2012	February 2013	No
Qtr 2 (Dec)	12/31/2012	February 2013	No
Qtr 3 (Mar)	3/31/2013	N/A	No
Qtr4 (June)	6/30/2013	September 2013	No

**How will revenue for the local funding cost share be established?** The county has executed a project cost sharing agreement with the USACE for the 50-year project life. St. Johns County has funded the USACE for the design of the 2011 re-nourishment effort based on the Federal Funding cost share and continues to retain the services of the coastal engineering firm Taylor Engineering, Inc. to assist in project management, tracking, monitoring, and assistance with design and permitting and other related future activities. St. Johns County is obtaining local funding for the project from the Tourist Development Council, which provides a dedicated and scheduled funding source. The county includes funds necessary to construct and maintain the project in the county's capital improvement plan.

**Is the funding from a dedicated long term source for this project?** Yes  
 St. Johns County is obtaining local funding for the project from the Tourist Development Council, which provides a dedicated and long-term funding source.

**In order to acquire funding, a resolution from the local governmental entity must be provided by the application deadline which declares:**

- Support from the sponsor for the proposed project
- Willingness to serve as the local sponsor
- Ability to provide the full local cost share
- Funding source

**Has the local sponsor resolution been attached to the application fulfilling all of these requirements?** Yes

**Has the State cost-shared in a feasibility or design phase of this project?** Yes  
 The Department entered into a cost-share agreement for funding of this project in 1995. The project is recommended in the Strategic Beach Management Plan and located in an area that has been designated as critically eroded shoreline by the Department.

**Previous State Cost Share Percentage:** (43.56%)

The current project construction is funded with 80.5% Federal; 11.8% County and 7.7% State.

**10-Year Project Schedule and 5-Year Estimated Budget**

**Does this project have Congressional Authorization?** Yes

**Does this project have a Federal Project Cooperative Agreement?** Yes

**What is the end date of the Federal Authorization?** N/A

**What is the Federal cost share available for this erosion control project?** 80.5%

**Schedule and Budget (Include estimated phases for 10 years and estimated project costs for 5 years.): Use only tasks Feasibility, Design, Construction and Monitoring**

Year	Proposed Method	Description	Total Estimated Cost	Federal Cost Share	State Cost Share	Local Cost Share
2014/ 2015	Monitoring		\$155,000	\$0	\$67,518	\$87,482
2015/ 2016	Monitoring		\$155,000	\$0	\$67,518	\$87,482
2016/ 2017	Monitoring		\$155,000	\$0	\$67,518	\$87,482
2017/ 2018	Construction	Nourishment	\$1,885,000	\$1,517,425	\$160,116	\$207,459
2018/ 2019	Construction	Nourishment	\$16,730,000	\$14,000,000	\$1,189,188	\$1,540,812
2019/ 2020	Monitoring		\$155,000	\$0	\$67,518	\$87,482
2020/ 2021	Monitoring					
2021/ 2022	Monitoring					
2022/ 2023	Monitoring					

**Mapping- Maps are provided as attachments.**

Maps should be to scale at a minimum of 1"=200'

Mapping elements include:

- Project Boundary with critically eroded shoreline.
- Range monuments.
- Beach access and parking- primary and secondary, including access widths.
- Public lodging establishments- locations and length of property boundaries along project Shoreline.
- Local Comprehensive Plan designations of commercial and recreational facilities and associated property boundaries along the project shoreline.

**What is the length of the project boundary in feet?** 15,170

**What is the length of commercial or recreational property fronting the project shoreline?**  
7,977.33

**What is the percentage of project shoreline designated as commercial or recreational property?**  
52.58%

**Current contract eligibility or proposed new eligibility** \_\_\_\_\_

**Eligibility: Access Points and Public Lodging Establishments:**

Location/Name	Address	R-Mon	Type of Access	Width of Access/ Frontage	Total units or parking spaces	Public Parking Spaces	Eligible shoreline (ft)
<b>Anastasia State Park</b>	<b>E of Anastasia Park Rd A1A</b>	<b>R137-R141</b>	<b>Primary</b>		<b>350</b>	<b>350</b>	<b>2640</b>
Pope Road		R141	Secondary			15 *	
St Augustine Beach Front Resort	300 A1A Beach Blvd	R141					
<b>Pier Park</b>		<b>R142</b>	<b>Primary</b>		<b>170</b>	<b>170</b>	<b>2640</b>
Hampton Inn	430 A1A Beach Blvd	R142					
16 <sup>th</sup> Street						16	
15 <sup>th</sup> Street						44	
14 <sup>th</sup> Street						12	
13 <sup>th</sup> Street						24	
12 <sup>th</sup> Street						13	
11 <sup>th</sup> Street						34	
10 <sup>th</sup> Street						24	
9 <sup>th</sup> Street						0	
8 <sup>th</sup> Street						18	
7 <sup>th</sup> Street						22	
6 <sup>th</sup> Street						5	
<b>5<sup>th</sup> Street</b>		<b>R145-R146</b>	<b>Secondary</b>		<b>56</b>	<b>56</b>	<b>1320</b>
4 <sup>th</sup> Street						0	
3 <sup>rd</sup> Street						40	

2 <sup>nd</sup> Street						4	
1 <sup>st</sup> Street						22	
<b>A Street</b>		<b>R146</b>	<b>Secondary</b>		<b>22</b>	<b>22</b>	<b>1320</b>
The Beachcomber	2 A Street						
B Street						4	
House of Sun & Sea	2 B Street						
C Street						8	
D Street		R147				10	
E Street						8	
<b>F Street</b>		<b>R148</b>	<b>Secondary</b>		<b>10</b>	<b>10</b>	<b>1056</b>
La Fiesta Oceanside Inn & Suite	810 A1A Beach Blvd	R148					
Holiday Inn	860 A1A Beach Blvd	R149					
<b>Maratea Beach Access</b>	<b>900 A1A Beach Blvd</b>	<b>R150</b>	<b>Secondary</b>		<b>20</b>	<b>20</b>	<b>1056</b>

- Pope Road revised to not include YMCA parking area

- **Additional Ranking Criteria**

**Will this project enhance or increase the longevity of a previously constructed project? How?**

Yes. This project has been designed to utilize frequent Renourishment cycles of sand every five years to re-establish the down drift beaches from prolonged erosion.

**Will this project nourish a previously restored shoreline?** YES

**What is the Rate of Erosion as determined by the Bureau? (ft/yr)** -11ft/yr

**Severity of Erosion:**

Significant

**Project Benefits:**

Significant benefit to the local economy and tourism industry along with the storm protection of critical infrastructure.

**Use of Innovative Applications of Existing Technologies:**

**Nourishment Interval (years):**

**Project Performance:** Five

**Is this project being planned or constructed in cooperation with another local government?**

**Explain.**

No

Local Government  
Department  
Address 1  
Address 2

Resort Condominium Name: \_\_\_\_\_  
Resort Address: \_\_\_\_\_  
DBPR License Number: \_\_\_\_\_

The referenced motel has a total of \_\_\_\_\_ units, of which \_\_\_\_\_ units are available to the public on a rental basis. Therefore, a total of \_\_\_\_\_ percent of the motel is available on a rental basis.

\_\_\_\_\_  
Signed:  
Title:  
  
\_\_\_\_\_  
Date

The above information was verbally provided by \_\_\_\_\_ on \_\_\_\_\_ (date).

\*\*\*\*\*

Local Government  
Department  
Address 1  
Address 2

Resort Condominium Name: \_\_\_\_\_  
Resort Address: \_\_\_\_\_  
DBPR License Number: \_\_\_\_\_

The referenced resort condominium has a total of \_\_\_\_\_ units, of which \_\_\_\_\_ are available to the public on a rental basis. Therefore, a total of \_\_\_\_\_ percent of the condominium is available on a rental basis.

\_\_\_\_\_  
Signed:  
Title:  
  
\_\_\_\_\_  
Date

The above information was verbally provided by \_\_\_\_\_ on \_\_\_\_\_ (date).

**Lodgings and Connected Businesses  
(Commercial)**

Licensee Name	Establishment	Address	License Type	License No	Exp. Date	LF Beach Front	No. of Rooms
Craven Properties Ltd	St Augustine Beach Front Resort	300 A1A Beach Blvd	Motel	MOT6500253	6/1/2014	476.7	142
	St Augustine Beach Front Resort		Permanent Food	SEA6500254	6/1/2014		
	St Augustine Beach Front Resort		Permanent Food	SEA6501748	Plan Review Approved		
	St Augustine Beach Front Resort		Retail Beverage	BEV6500035	9/30/2013		
Arvin Enterprises Inc	Hampton Inn	430 A1A Beach Blvd	Motel	MOT6501360	6/1/2014	178.7	100
	Hampton Inn		Permanent Food Service	SEA6501361	6/1/2014		
St Augustine Resort Inc	Holiday Inn	860 A1A Beach Blvd	Hotel	HOT6500300	6/1/2014	202.8	153
	Beach Garden Restaurant		Permanent Food Service	SEA6500314	6/1/2014		
810 Beach Inc	Beachfront Bed & Breakfast	810 A1A Beach Blvd	Bed & Breakfast	BNB6500124	6/1/2014	199	8
	La Fiesta Oceanside Inn & Suite		Motel	MOT6500011	6/1/2014	199	45
	Beachfront Bed & Breakfast		Permanent Food Service	SEA6501386	6/1/2014		
	Fiesta Falls Mini Golf		Permanent Food Service	NOS6501693	6/1/2014		
	La Fiesta Oceanside Inn & Suite		Permanent Food Service	NOS6501697	6/1/2014		
Steder, Patricia B.	House of Sea & Sun	2 B Street	Bed & Breakfast	BNB6501391	6/1/2014	90.2	6
	House of Sea & Sun		Permanent Food Service	SEA6501390	6/1/2014		
Chautauqua Beach Comber Inc	The Beachcomber	2 A Street	Permanent Food Service	SEA6500513	6/1/2014	47.7	NA
			Retail Beverage	BEV6500363	9/30/2013		
						1394.1	454

						Total LF	Total Rms			
						LF Beach Front	# Condo Units	% rentals	no of rentals	Eligible
<b>Condominiums</b>										
Ocean Villas, A Condo	Ocean Villas, A Condo	850 A1A Beach Blvd	Vacation Condo	CND6500015	6/1/2013	419.81	138	55%	79	230.90
						Delinquent/Active				
St. Augustine Ocean & Racquet Club One, A Condo		880 A1A Beach Blvd	Condominium Project	CND6500016	6/1/2014	600.01	279	50%	141	300.01
Sea Winds Condo	Sea Winds Condo	890 A1A Beach Blvd	Condominium Project	CND6501622	6/1/2014	320.11	80	50%	40	160.06
Island South Condominiums		620 A1A Beach Blvd	Condominium Project	PR1P003118	1/1/2014	185.32	36	39%	14	72.27
						1525.25	533		274	763.23

<b>(Recreational)</b>		
Site	Beach Frontage (LF)	
Anastasia State Park	4670	
County Pier	630	
City of St Aug Beach REC	520	

5820 LF - Recreational  
 2157.33 LF - Commercial  
7977.3303 LF - Commercial and Recreational

Pier Point South Condominiums	390 A1A Beach Blvd	Condominium Project	CND6500013	6/1/2014	341.05	471-3622
Endless Summer Condominiums	1 16th Street	Condominium Project	PR1V023550	1/1/2014	116.09	no phone number
See Ray Shores Condominiums	1 10th Street	Condominium Project	PR75451	1/1/2014	101.31	461-1197
Surfside Six Condominiums	2 10th Street	Condominium Project	not listed under this name		94.87	no phone number
Sea Oats Villas Condominiums	2 E Street	Condominium Project	PR1S014424	1/1/2014	92.99	no phone number

# St. Johns County Beach Renourishment

St. Augustine Beach Monuments R 137 to R 151

**Legend**

- Survey Monuments
- Beach Access Sites
- Public Parking

**Land Use**

- Houses and Mixes
- Bed and Breakfast Inns
- Commercial
- Recreation and Open Space
- Single Family Residential
- Multi Family Residential
- Condominium/Multi-Owner

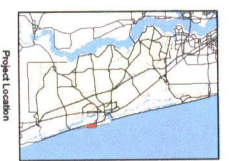
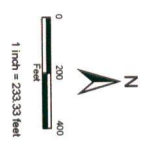

DISCLAIMER: This map is for reference use only. Data provided or derived from multiple sources with no warranty or responsibility for accuracy by the County or its employees.

Map Prepared: 8/22/2012  
1/18/2010

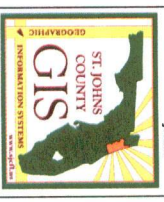

Section 3

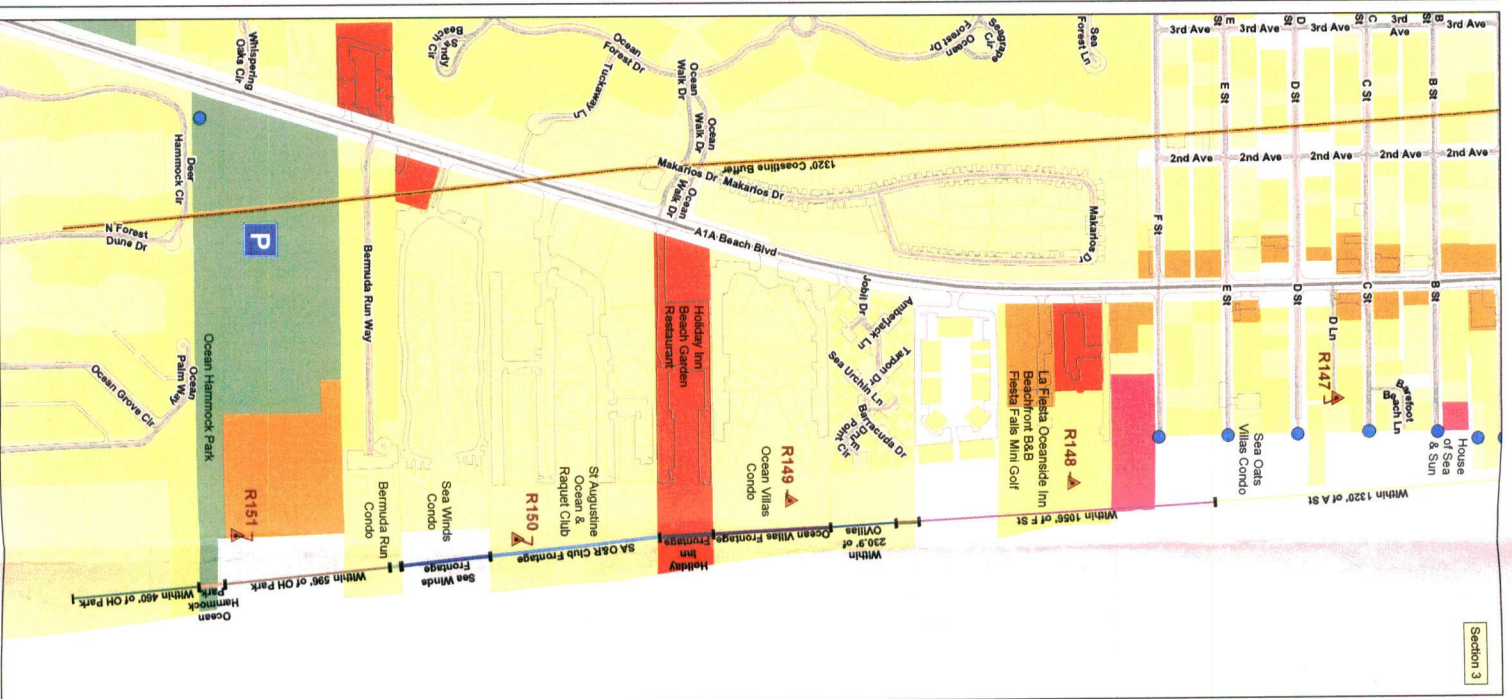

Section 2

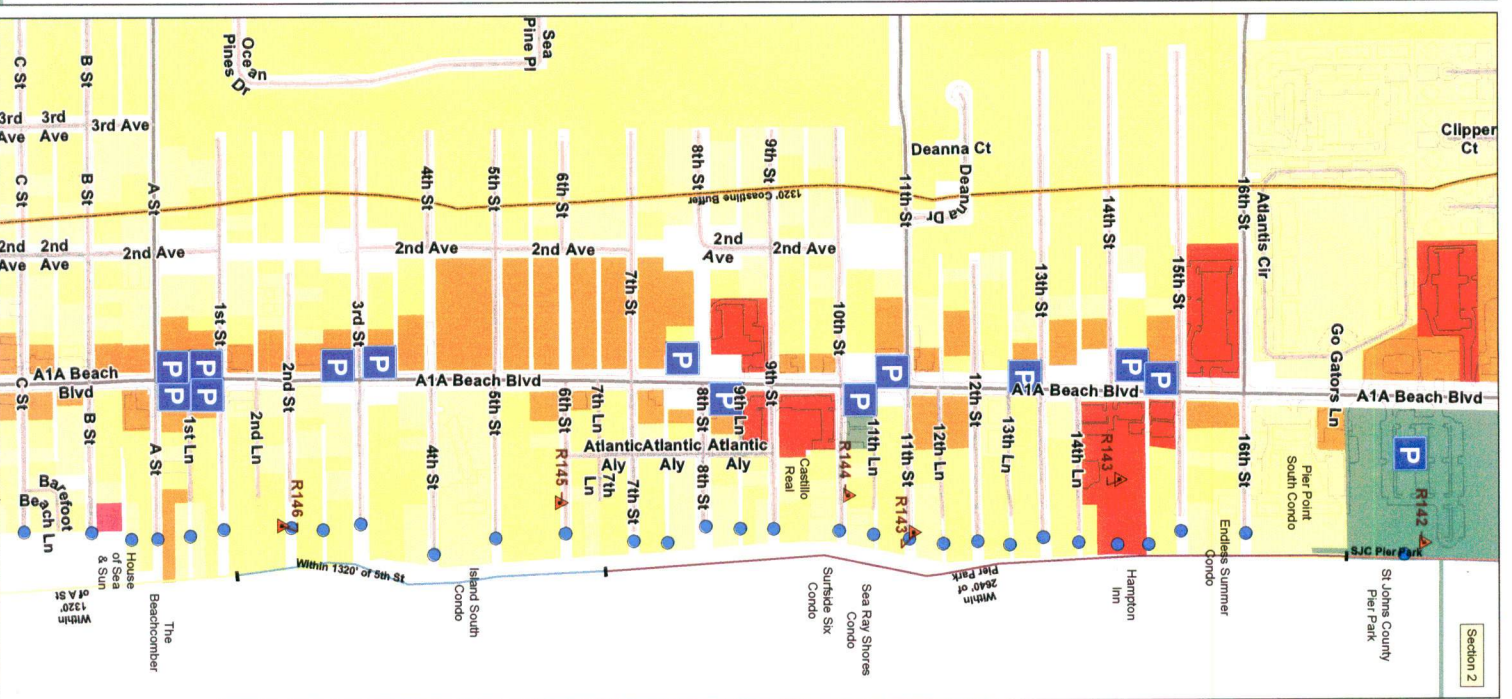

Section 1

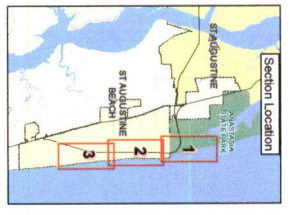

# St. Johns County Beach Renourishment

St. Augustine Beach Monuments R 137 to R 151

- Legend**
- Survey Monument
  - Beach Access Stiles
  - Public Parking
  - 2011 Aerial Photography

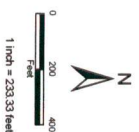

DISCLAIMER: This map is for reference use only. It is not intended to be used as a legal document. The user assumes all liability for any use of this map. The user agrees to hold the provider of this map harmless for any use of this map. The provider of this map is not responsible for any use of this map.

Map Prepared: 8/2/2012  
113288

