

RESOLUTION NO. 2018- 235

**A RESOLUTION BY THE BOARD OF COUNTY COMMISSIONERS OF ST. JOHNS COUNTY, FLORIDA, AUTHORIZING THE CHAIR OF THE BOARD, ON BEHALF OF THE COUNTY, TO EXECUTE AND DELIVER A COUNTY QUITCLAIM DEED AND SUBORDINATION AGREEMENT TO THE STATE OF FLORIDA DEPARTMENT OF TRANSPORTATION CONVEYING AND SUBORDINATING ANY COUNTY INTEREST IN CERTAIN LANDS NEEDED FOR STATE ROAD 16 IMPROVEMENTS AT THE PROPOSED SILVERLEAF PARKWAY.**

**RECITALS**

**WHEREAS**, the State of Florida Department of Transportation ("FDOT") proposes to construct or improve State Road 16, Section No. 78006, F. P. No. 4376301, in St. Johns County, Florida, at its intersection with the proposed Silverleaf Parkway; and

**WHEREAS**, it is necessary that certain interests now owned by St. Johns County ("County") be acquired by FDOT for the project; and

**WHEREAS**, per the requirements of Section 125.38, Florida Statutes, FDOT has made application to the County to execute and deliver a County QuitClaim Deed, attached hereto as Exhibit "A", together with a Subordination Agreement, attached hereto as Exhibit "B", in favor of FDOT, for a nominal fee, conveying and subordinating all rights, title and interest that the County has in and to said described land required for transportation purposes which is in the public or community interest for public welfare and said request having been duly considered.

**NOW, THEREFORE, BE IT RESOLVED** by the Board of County Commissions of St. Johns County, Florida, as follows:

Section 1. The above Recitals are incorporated by reference into the body of this Resolution and such Recitals are adopted as findings of fact.

Section 2. The Board of County Commissioners hereby authorizes the Chair of the Board, on behalf of the County, to execute and deliver to FDOT the County QuitClaim Deed and Subordination Agreement, attached hereto.

Section 3. The Clerk is instructed to record the original County QuitClaim Deed and Subordination Agreement in the public records of St. Johns County, Florida, and return the original recorded County QuitClaim Deed and Subordination Agreement along with a certified copy of this Resolution to the State of Florida Department of Transportation, 1109 South Marion Avenue, MS 2020, Lake City, Florida 32025-5874, Attention: Kelly Joslin.

Section 4. To the extent that there are typographical and/or administrative errors that do not change the tone, tenor, or concept of this Resolution, then this Resolution may be revised without subsequent approval by the Board of County Commissioners.

**PASSED AND ADOPTED** by the Board of County Commissioners of St. Johns County, Florida, this 7<sup>th</sup> day of August, 2018.

**BOARD OF COUNTY COMMISSIONERS OF  
ST. JOHNS COUNTY, FLORIDA**

By: Henry Dean  
Henry Dean, Chair

**ATTEST:** Hunter S. Conrad, Clerk

By: Pam Halterman  
Deputy Clerk

RENDITION DATE 8/9/18

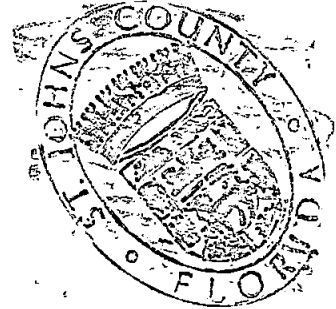

Exhibit "A" to Resolution

04-QCD.12-Date: June 19, 2018

This instrument prepared by  
or under the direction of:  
David M. Robertson  
Chief Counsel District Two  
Florida Department of Transportation  
1109 South Marion Avenue  
Lake City, Florida 32025-5874

PARCEL NO. 100.2  
SECTION NO. 78060  
F.P. NO. 4376301  
STATE ROAD NO. 16  
COUNTY OF St. Johns

**COUNTY QUITCLAIM DEED**

THIS QUITCLAIM DEED, Made this \_\_\_\_\_ day of \_\_\_\_\_, 2018, by ST. JOHNS COUNTY, FLORIDA, a political subdivision of the State of Florida, 500 San Sebastian View, St. Augustine, Florida 32086, grantor, to the STATE OF FLORIDA DEPARTMENT OF TRANSPORTATION, 1109 South Marion Avenue, Lake City, Florida 32025-5874, grantee: (Wherever used herein the terms "grantor" and "grantee" include all the parties to this instrument and the heirs, legal representatives and assigns of individuals, and the successors, and assigns of organizations).

WITNESSETH: That the said grantor, for and in consideration of the sum of One Dollar (\$1.00) and other valuable considerations, receipt and sufficiency being hereby acknowledged, does hereby remise, release and quitclaim unto the said grantee forever, all right, title, interest, claim and demand, which said grantor has in and to the hereinafter described parcel of land arising out of that certain Planned Unit Development for Silverleaf Plantation PUD as evidenced by Ordinance No. 2006-117 and recorded in Official Records Book 2805, Page 1853, as modified by Ordinance No. 2016-38 Silverleaf PUD recorded in Official Records Book 4250, Page 1056; Utility Service and Refund Agreement recorded in Official Records Book 2806, Page 842, together with First Amendment recorded in Official Records Book 3242, Page 995; Partial Release Utility Service and Refund Agreement recorded in Official Records Book 4140, Page 1035 and Partial Release Utility Service and Refund Agreement recorded in Official Records Book 4140, Page 1341 and amended and restated by Amended and Restated Utility Service and Refund Agreement recorded in Official Records Book 4283, Page 1795; Master Development Plan SILVERLEAF PUD recorded in PUD drawing Book 29, Pages 13 – 51; and Impact Fee Credit Agreement recorded in Official Records Book 4449, Page 939, all in the Public Records of

St. Johns County Florida, together with all other right, title, interest, claim and demand, if any, which the said grantor has in and to said parcel situate in the County of St. Johns, Florida, to wit:

SEE **Exhibit "A"**, attached hereto and by reference made a part hereof.

TO HAVE AND TO HOLD, the same together with the appurtenances thereunto belonging or in anywise appertaining, and all the estate, right, title, interest, lien, equity and claim whatsoever of the said grantor, either in law or equity, to the said grantee forever.

IN WITNESS WHEREOF, the said grantor has caused these presents to be executed in its name by its Board of County Commissioners acting by the Chairperson or Vice-Chairperson of said Board, the day and year aforesaid.

ATTEST: \_\_\_\_\_

Print Name: \_\_\_\_\_

Clerk (or Deputy Clerk)

St. Johns County, Florida  
by its Board of County Commissioners

BY: \_\_\_\_\_

Print Name: \_\_\_\_\_

Its Chairperson (or Vice-Chairperson)

Exhibit "A"

SECTION 78060  
F.P. 4376301

STATE ROAD NO. 16

ST. JOHNS COUNTY

PARCEL 100

FEE SIMPLE

A Part Of Grant Tract 5, Section 38 Of The Antonio Huertas Grant, Township 6 South, Range 28 East, As Per Deed Book Q, Page 495 Of The Current Public Records Of St. Johns County, Florida, Being More Particularly Described As Follows:

**Commence** At A 1-1/4 Inch Iron Pipe With No Identification At The Northeasterly Corner Of Grant Tract 5, Section 38 Of The Antonio Huertas Grant, Township 6 South, Range 28 East, As Per Deed Book Q, Page 495 Of The Current Public Records Of St. Johns County, Florida; Thence South 18°40'11" West, Along The Easterly Line Of Said Grant Tract 5, A Distance Of 3,921.73 Feet To The Baseline Of Survey Of State Road No. 16 (A 200 Foot Right Of Way, As Per Florida Department Of Transportation Right Of Way Map F.P. No. 4376301, Section 78060), Thence North 55°53'56" West, Along Said Baseline Of Survey, A Distance Of 1,460.78 Feet, Thence North 34°06'04" East, A Distance Of 100.00 Feet To The Northerly Existing Right Of Way Line Of Said State Road No. 16 And To The **Point Of Beginning**; Thence North 55°53'56" West, Along Said Northerly Existing Right Of Way Line, A Distance Of 756.47 Feet To A Curve To The Left, Having A Radius Of 50.00 Feet; Thence Along Said Curve, Through An Angle Of 36°24'42", An Arc Distance Of 31.78 Feet, And A Chord Bearing And Distance Of South 74°06'17" East, 31.24 Feet To A Curve To The Left, Having A Radius Of 173.00 Feet; Thence Along Said Curve, Through An Angle Of 36°44'43", An Arc Distance Of 110.95 Feet, And A Chord Bearing And Distance Of North 69°19'00" East, 109.06 Feet; Thence South 48°12'56" East, A Distance Of 151.71 Feet To A Curve To The Left, Having A Radius Of 50.00 Feet; Thence Along Said Curve, Through An Angle Of 105°45'24", An Arc Distance Of 92.29 Feet, And A Chord Bearing And Distance Of South 03°01'14" East, 79.74 Feet; Thence South 55°53'56" East, A Distance Of 461.17 Feet To Said Northerly Existing Right Of Way Line; Thence South 18°12'18" West, Along Said Northerly Existing Right Of Way Line, A Distance Of 15.60 Feet To The **Point Of Beginning**.

Containing 0.558 Acres, More Or Less.

Exhibit "B" to Resolution

36-SUB.03-Date: June 19, 2018

This instrument prepared by  
or under the direction of:  
David M. Robertson  
Chief Counsel District Two  
Florida Department of Transportation  
1109 South Marion Avenue  
Lake City, Florida 32025-5874

PARCEL NO. 800.2  
SECTION NO. 78060  
F.P. NO. 4376301  
STATE ROAD NO. 16  
COUNTY OF St. Johns

**SUBORDINATION AGREEMENT**

THIS AGREEMENT made this \_\_\_\_\_ day of \_\_\_\_\_, 2018, by and between ST. JOHNS COUNTY, FLORIDA, a political subdivision of the State of Florida, 500 San Sebastian View, St. Augustine, Florida 32086, hereinafter called the "party of the first part", and the STATE OF FLORIDA DEPARTMENT OF TRANSPORTATION, 1109 South Marion Avenue, Lake City, Florida 32025-5874, hereinafter called the "Department".

**WITNESSETH:**

WHEREAS, the party of the first part is the owner and holder of that certain Planned Unit Development for Silverleaf Plantation PUD as evidenced by Ordinance No. 2006-117 and recorded in Official Records Book 2805, Page 1853, as modified by Ordinance No. 2016-38 Silverleaf PUD recorded in Official Records Book 4250, Page 1056; Utility Service and Refund Agreement recorded in Official Records Book 2806, Page 842, together with First Amendment, recorded in Official Records Book 3242, Page 995; Partial Release Utility Service and Refund Agreement recorded in Official Records Book 4140, Page 1035 and Partial Release Utility Service and Refund Agreement recorded in Official Records Book 4140, Page 1341 and amended and restated by Amended and Restated Utility Service and Refund Agreement recorded in Official Records Book 4283, Page 1795; Master Development Plan SILVERLEAF PUD recorded in PUD drawing Book 29, Pages 13 – 51; and Impact Fee Credit Agreement recorded in Official Records Book 4449, Page 939, all in the Public Records of St. Johns County Florida, and;

WHEREAS, a portion of the land encumbered by said Planned Unit Development for Silverleaf Plantation PUD as evidenced by Ordinance No. 2006-117; as modified by Ordinance No. 2016-38 Silverleaf PUD; Utility Service and Refund Agreement; First Amendment; Partial Release Utility Service and Refund Agreement; Partial Release Utility Service and Refund Agreement; and amended and restated by Amended and Restated Utility Service and Refund Agreement; Master Development Plan SILVERLEAF PUD; and Impact Fee Credit Agreement are required by the Department for public transportation purposes;

NOW THEREFORE, for and in consideration of the sum of One Dollar (\$1.00) and other good and valuable considerations, paid, the receipt and sufficiency of which is hereby acknowledged, the party of the first part hereby agrees, covenants, and consents with the Department that the aforesaid Planned Unit Development for Silverleaf Plantation PUD as evidenced by Ordinance No. 2006-117; as modified by Ordinance No. 2016-38 Silverleaf PUD; Utility Service and Refund Agreement; First Amendment; Partial Release Utility Service and Refund Agreement; Partial Release Utility Service and Refund Agreement; and amended and restated by Amended and Restated Utility Service and Refund Agreement; Master Development Plan SILVERLEAF PUD; and Impact Fee Credit Agreement are and shall continue to be subject and subordinate to the property rights of the Department insofar as said Planned Unit Development for Silverleaf Plantation PUD as evidenced by Ordinance No. 2006-117; as modified by Ordinance No. 2016-38 Silverleaf PUD; Utility Service and Refund Agreement; First Amendment; Partial Release Utility Service and Refund Agreement; Partial Release Utility Service and Refund Agreement; and amended and restated by Amended and Restated Utility Service and Refund Agreement; Master Development Plan SILVERLEAF PUD; and Impact Fee Credit Agreement affect the following described property, viz:

SEE Exhibit "A", attached hereto and by reference made a part hereof.

This subordination agreement shall be binding upon and inure to the benefit of the respective heirs, legal representatives, successors and assigns of the parties hereto.

IN WITNESS WHEREOF, the said grantor has caused these presents to be executed in its name by its Board of County Commissioners acting by the Chairperson or Vice-Chairperson of said Board, the day and year aforesaid.

ATTEST: \_\_\_\_\_  
Print Name: \_\_\_\_\_  
Clerk (or Deputy Clerk)

St. Johns County, Florida  
by its Board of County Commissioners

BY: \_\_\_\_\_  
Print Name: \_\_\_\_\_  
It's Chairperson (or Vice-Chairperson)

STATE OF FLORIDA  
COUNTY OF ST. JOHNS

The foregoing instrument was acknowledged before me this \_\_\_\_\_ day of \_\_\_\_\_, 20\_\_\_\_, by \_\_\_\_\_, Chairperson (or Vice-Chairperson),  who is personally known to me or  who has produced \_\_\_\_\_ as identification.

(Notary Seal)

Print Name: \_\_\_\_\_  
Notary Public  
My Commission Expires: \_\_\_\_\_

Exhibit "A"

SECTION 78060  
F.P. 4376301

STATE ROAD NO. 16

ST. JOHNS COUNTY

PARCEL 800

PERMANENT EASEMENT

A Part Of Grant Tract 5, Section 38 Of The Antonio Huertas Grant, Township 6 South, Range 28 East, As Per Deed Book Q, Page 495 Of The Current Public Records Of St. Johns County, Florida, Being More Particularly Described As Follows:

**Commence** At A 1-1/4 Inch Iron Pipe With No Identification At The Northeasterly Corner Of Grant Tract 5, Section 38 Of The Antonio Huertas Grant, Township 6 South, Range 28 East, As Per Deed Book Q, Page 495 Of The Current Public Records Of St. Johns County, Florida; Thence South 18°40'11" West, Along The Easterly Line Of Said Grant Tract 5, A Distance Of 3,921.73 Feet To The Baseline Of Survey Of State Road No. 16 (A 200 Foot Right Of Way, As Per Florida Department Of Transportation Right Of Way Map F.P. No. 4376301, Section 78060); Thence North 55°53'56" West, Along Said Baseline Of Survey, A Distance Of 2217.24 Feet; Thence North 34°06'04" East, A Distance Of 100.00 Feet To The Northerly Existing Right Of Way Line Of Said State Road No. 16 And To The **Point Of Beginning**. Thence North 55°53'56" West, Along Said Northerly Existing Right Of Way Line, A Distance Of 195.53 Feet; Thence North 34°06'04" East, A Distance Of 18.12 Feet To A Curve To The Right, Having A Radius Of 65.00 Feet; Thence Along Said Curve, Through An Angle Of 118°25'21", An Arc Distance Of 134.35 Feet, And A Chord Bearing And Distance Of North 21°07'41" East, 111.68 Feet To A Curve To The Left, Having A Radius Of 187.00 Feet; Thence Along Said Curve, Through An Angle Of 93°54'03", An Arc Distance Of 306.47 Feet, And A Chord Bearing And Distance Of North 33°23'20" East, 273.31 Feet To A Curve To The Right, Having A Radius Of 65.00 Feet; Thence Along Said Curve, Through An Angle Of 109°36'15", An Arc Distance Of 124.34 Feet, And A Chord Bearing And Distance Of North 41°14'26" East, 106.23 Feet To A Curve To The Left, Having A Radius Of 187.00 Feet; Thence Along Said Curve, Through An Angle Of 100°51'31", An Arc Distance Of 329.18 Feet, And A Chord Bearing And Distance Of North 45°36'48" East, 288.29 Feet To A Curve To The Right, Having A Radius Of 65.00 Feet; Thence Along Said Curve, Through An Angle Of 100°40'24", An Arc Distance Of 114.21 Feet, And A Chord Bearing And Distance Of North 45°31'14" East, 100.08 Feet; Thence South 84°08'34" East, 22.54 Feet To A Curve To The Right, Having A Radius Of 100.00 Feet; Thence Along Said Curve, Through An Angle Of 95°32'35", An Arc Distance Of 166.75 Feet, And A Chord Bearing And Distance Of South 36°22'17" East, 148.09 Feet To A Curve To The Right, Having A Radius Of 1,095.00 Feet; Thence Along Said Curve, Through An Angle Of 42°27'17", An Arc Distance Of 811.37 Feet, And A Chord Bearing And Distance Of South 32°37'39" West, 792.93 Feet To A Curve To The Right, Having A Radius Of 60.00 Feet; Thence Along The Arc Of Said Curve, Through An Angle Of 24°05'05", An Arc Distance Of 25.22 Feet, And A Chord Bearing And Distance Of South 65°53'50" West, 25.04 Feet; Thence South 49°35'24" East, A Distance Of 20.61 Feet To A Curve To The Right, Having A Radius Of 173.00 Feet; Thence Along Said Curve, Through An Angle Of 10°40'05", An Arc Distance Of 32.21 Feet And A Chord Bearing And Distance Of South 82°21'20" West, 32.16 Feet To A Curve To The Right,

Having A Radius Of 50.00 Feet; Thence Along The Arc Of Said Curve, Through An Angle Of 36°24'42", An Arc Distance Of 31.78 Feet, And A Chord Bearing And Distance Of North 74°06'17" West, 31.24 Feet To The **Point Of Beginning**.

Containing 5.269 Acres, More Or Less.

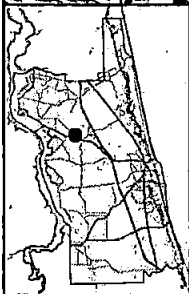

0 110 220  
Feet

2016 Aerial Imagery  
July 9, 2018

State Road 16  
Improvements

Silverleaf Parkway

Land Management  
Systems  
Real Estate  
Division  
(904) 209-0790

Disclaimer:  
This map is for reference use only.  
Data provided are derived from multiple  
sources with varying levels of accuracy.  
The St. Johns County Real Estate  
Division disclaims all responsibility  
for the accuracy or completeness  
of the data shown hereon.

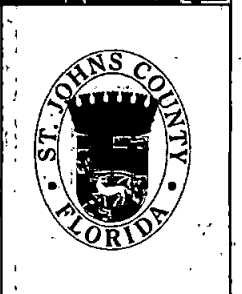

ANTONIO HUERTAS GRANT, SECTION 38,  
TOWNSHIP 6 SOUTH, RANGE 28 EAST

SUBDIVISION OF THE ANTONIO HUERTAS GRANT  
DEED BOOK Q, PAGE 495

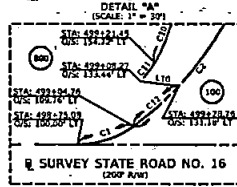

CURVE DATA					
CURVE	Δ	RADIUS	LENGTH	CHORD DISTANCE	CHORD BEARING
C1	36°24'42"	90.00'	31.78'	31.24'	S74°08'17"E
C2	36°44'43"	173.00'	110.85'	109.04'	R89°19'00"E
C3	105°45'24"	130.00'	92.25'	79.74'	S03°01'14"E
C4	118°29'21"	83.00'	134.33'	111.64'	N21°07'01"E
C5	93°34'03"	187.00'	306.47'	273.31'	N33°23'22"E
C6	109°39'19"	65.00'	126.34'	108.23'	N41°34'28"E
C7	100°31'23"	183.00'	139.84'	208.29'	R83°28'43"E
C8	100°49'24"	65.00'	114.21'	100.68'	R45°31'14"E
C9	95°32'35"	100.00'	164.75'	144.29'	S36°22'17"E
C10	42°22'17"	1,095.00'	811.33'	792.93'	S26°37'39"W
C11	24°05'05"	60.00'	75.77'	75.64'	S45°39'50"W
C12	19°45'05"	173.00'	32.21'	32.16'	S82°21'50"W

LINE TABLE		
LINE	BEARING	DISTANCE
L1	N34°05'04"E	100.00'
L2	R35°33'34"W	750.43'
L3	S48°19'56"E	151.33'
L4	S55°33'50"E	461.11'
L5	S16°12'18"W	15.80'
L6	R16°05'51"E	180.00'
L7	R55°23'35"W	123.53'
L8	N34°05'04"E	116.12'
L9	S44°02'34"E	22.54'
L10	S43°35'24"E	70.61'
L11	N14°05'04"E	100.00'

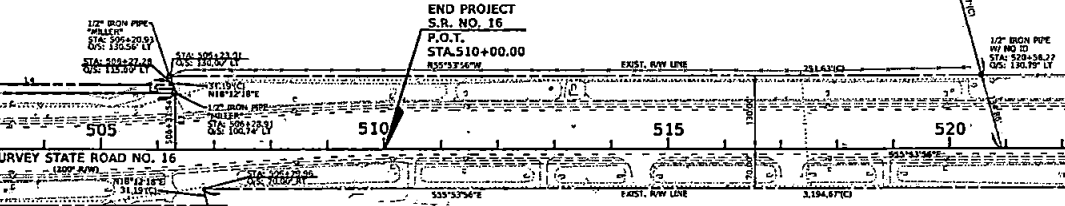

GENERAL NOTES

- THIS MAP IS BASED ON THE FLORIDA STATE PLANE COORDINATE SYSTEM, EAST ZONE (801), 1983 NORTH ANCHOR DATUM (83-211), ORIGIN: A POINT OF SOUTH 51° 3' 34" EAST ON THE BASELINE OF SURVEY STATE ROAD NO. 16 BETWEEN STATION 486+79.55 (NORTHING: 227481.6411 EASTING: 497810.1751) AND STATION 514+00.00 (NORTHING: 226951.2544 EASTING: 495003.8711).
- THIS RIGHT OF WAY MAP IS SUPPORTED BY CAACE DATABASE 780614 DATED MAY 01, 2017, PREPARED UNDER THE RESPONSIBLE CHARGE OF DRAGON ROODERS, FLORIDA PROFESSIONAL SURVEYOR AND MEMBER NUMBER 9411. A CERTIFIED COPY OF THIS DATABASE IS AVAILABLE FROM THE DISTRICT 2 OFFICE IN LAKE CITY, FLORIDA.
- THIS RIGHT OF WAY MAP WAS PREPARED FOR THE PURPOSE OF PREPARING LEGAL LAND DESCRIPTIONS, ACQUISITION DOCUMENTS, NEIGHBORHOOD PROPERTY MANAGEMENT AND AS AN AID IN THE APPRAISAL OF THE RIGHT OF WAY REQUIRED FOR TRANSPORTATION FACILITIES. THIS MAP IS NOT A SURVEY.
- ALL TOPOGRAPHIC INFORMATION SHOWN HEREON PERTAINING TO RIGHT OF WAY ACQUISITION AND PROPOSED EASEMENTS FROM CAACE DATABASE 780614.
- ONLY FIXED IMPROVEMENTS PERTINENT TO THE PARCELS TO BE ACQUIRED ARE SHOWN.
- ALL TIES SHOWN REFER TO THE BASELINE OF SURVEY, UNLESS OTHERWISE NOTED.
- PROPERTY BOUNDARIES DETERMINED FROM PLATS OF RECORD AND RECORD TITLE.
- UNDERGROUND UTILITIES AND ENCROACHMENTS ARE NOT LOCATED.
- RIGHT OF WAY MONUMENTS ARE TO BE SET AFTER CONSTRUCTION OF THE PROJECT IS COMPLETE.
- ATTENTION IS DIRECTED TO THE FACT THESE MAPS MAY HAVE BEEN ALTERED IN SIZE BY REPRODUCTION. THIS MUST BE CONSIDERED WHEN OBTAINING SCALED DATA.

LEGEND

- |        |   |                   |                     |   |     |
|--------|---|-------------------|---------------------|---|-----|
| B      | = | BASELINE          | PARCEL NUMBER       | = | 100 |
| C1     | = | CURVE NUMBER      | MAIL & DECK         | = | 101 |
| Δ      | = | CURVE DELTA ANGLE | FIRE HYDRANT        | = | 102 |
| F.P.   | = | FRANCHISE PRODUCT | GUY ANCHOR          | = | 103 |
| ID     | = | IDENTIFICATION    | WATER VALVE         | = | 104 |
| IP     | = | IRON PIPE         | WATER METER         | = | 105 |
| JPC    | = | IRON PIPE AND CAP | DRAINAGE MARKOLE    | = | 106 |
| LN     | = | LINE NUMBER       | SEWER MANHOLE       | = | 107 |
| LB     | = | LOCKAGE BUSINESS  | POWER POLE          | = | 108 |
| LT     | = | LEFT              | SHARED POLE         | = | 109 |
| NO.    | = | NUMBER            | SINGLE SUPPORT SIGN | = | 110 |
| P.O.T. | = | POINT ON TANGENT  | GAS VALVE           | = | 111 |
| R      | = | RIGHT             | BREAK IN SCALE      | = | 112 |
| RT     | = | RIGHT OF WAY      |                     |   |     |
| STN.   | = | STATION NUMBER    |                     |   |     |
| S.R.   | = | STATE ROAD        |                     |   |     |
- BASELINE  
EXISTING RW LINE  
GRADE TIE  
PERPENDICULAR TIE  
PROPOSED PERPETUAL EASEMENT  
PROPOSED RIGHT OF WAY LINE  
QUARTER SECTION LINE
- CLURB & GUTTER  
DITCH PAVEMENT  
FENCE LINE  
LANE LINE  
OVERHEAD ELECTRIC LINE  
OVERHEAD TELEPHONE LINE

TABLE OF OWNERSHIP		PARCEL NUMBER ID	TYPE USE	PARCEL NUMBER ID	TYPE USE	PARCEL NUMBER ID	TYPE USE
100	1	WHY'S FORD TIMBER, LLC	0.368 AC.	100-199	TEMPORARY EASEMENT	800-897	TEMPORARY EASEMENT
100	1	WHY'S FORD TIMBER, LLC	0.270 AC.	100-AC (UNRECORDED)	R.A.	CRD	NO

APPROVED BY	DATE	BY	DATE	FED. PROJ. N/A	SECTION 78060	MAP PREPARED BY: PORTAL, INC. (REGISTERED PROFESSIONAL ENGINEER, FLORIDA LICENSE NO. 11207)	DATA SOURCE: CAACE DATABASE 780614
BYRON	05-08-2018	BYRON	05-08-2018	STATE ROAD NO. 16	ST. JOHNS COUNTY	F.P. NO. 4376301	SHEET 1 OF 1

ST. JOHNS COUNTY, FLORIDA

DETAIL SHEET  
THIS MAP IS NOT A SURVEY  
STATE ROAD NO. 16 AT  
COUNTY ROAD NO. 16A