

RESOLUTION 2020 - 39

A RESOLUTION OF THE BOARD OF COUNTY COMMISSIONERS OF ST. JOHNS COUNTY, FLORIDA, APPROVING THE TERMS OF AN INTERLOCAL AGREEMENT BETWEEN ST. JOHNS COUNTY, FLORIDA, (COUNTY) AND THE ST. AUGUSTINE PORT, WATERWAY AND BEACH DISTRICT (DISTRICT) FOR THE BENEFIT OF THE PUBLIC; AUTHORIZING THE CHAIR OF THE BOARD OF COUNTY COMMISSIONERS OF ST. JOHNS COUNTY, FLORIDA, TO EXECUTE THE INTERLOCAL AGREEMENT ON BEHALF OF THE COUNTY; AND INSTRUCTING THE CLERK OF THE CIRCUIT COURT TO FILE THE INTERLOCAL AGREEMENT IN THE PUBLIC RECORDS OF ST. JOHNS COUNTY.

RECITALS

WHEREAS, Florida Statutes authorize governmental units to cooperate to provide services for mutual benefit; and

WHEREAS, the County desires to accept reimbursement for up to \$75,000.00 from the District for enhancing Doug Crane Landing by constructing two (2) floating docks and two (2) gangway walkout; and

WHEREAS, the governing bodies of each jurisdiction recognize the benefits that may be afforded to the citizens by the Agreement; and

WHEREAS, the County has reviewed the terms of the Interlocal Agreement, attached hereto as "Exhibit A" and incorporated herein by reference; and

WHEREAS, the County has determined that accepting the terms of the Interlocal Agreement, and executing said Interlocal Agreement will serve the interests of the County.

NOW, THEREFORE BE IT RESOLVED BY THE BOARD OF COUNTY COMMISSIONERS OF ST. JOHNS COUNTY, FLORIDA, as follows:

Section 1. The above recitals are incorporated by reference into the body of this Resolution and such recitals are adopted as findings of fact.

Section 2. The Board of County Commissioners of St. Johns County hereby approves the terms and conditions of the Interlocal Agreement and authorizes the Chair of the Board of County Commissioners to execute said Interlocal Agreement on behalf of the County. To the extent that there are typographical errors that do not change the tone, tenor or concept of the Resolution, then this Resolution may be revised without subsequent approval by the Board of County Commissioners.

Section 3. The Clerk of Courts of St. Johns County is instructed to file the Agreement in the public records of St. Johns County.

PASSED AND ADOPTED, this 4 day of February, 2020.

BOARD OF COUNTY COMMISSIONERS
ST. JOHNS COUNTY, FLORIDA.

By: 
Jeb S. Smith, Chair

ATTEST: Brandon Patty, Clerk

(Seal)
BY: 
Deputy Clerk

RENDITION DATE 2/6/20



INTERLOCAL AGREEMENT

TO PROVIDE FOR FUNDING FOR LAUNCHING AND LANDING FACILITIES IN ST. JOHNS COUNTY

This Agreement is made and entered into by and between the **ST. AUGUSTINE PORT, WATERWAY AND BEACH DISTRICT**, a special district organized under the laws of the State of Florida (hereinafter referred to as "District"), and St. Johns County, a municipal corporation organized and existing under the laws of the State of Florida (hereinafter referred to as "COUNTY"):

WHEREAS, the COUNTY, in order to enhance the usefulness of the waterways within the COUNTY and to improve boating safety, is engaged in the maintenance of launching and landing facilities of the COUNTY; and

WHEREAS, the COUNTY finds that procurement of services for enhancing landing and launching facilities located on the COUNTY'S waterways furthers the health, safety and welfare of the public; and

WHEREAS, the DISTRICT has a legitimate governmental interest in enhancing public safety by providing financial support to COUNTY for such purposes; and

WHEREAS, the COUNTY and the DISTRICT find that the launching and landing facilities require maintenance and renovations; and

NOW, THEREFORE, in consideration of the mutual covenants and agreements contained herein, the parties agree as follows:

1. This Agreement is entered into pursuant to the Florida Interlocal

Cooperation Act of 1969, Section 163.01, *et seq.*, Florida Statutes (hereinafter referred to as the "Act"), and pursuant to powers granted by law to the COUNTY and to the DISTRICT.

2. In order to provide for the enhancements of Doug Crane Landing, the DISTRICT shall appropriate a sum not to exceed SEVENTY FIVE THOUSAND DOLLARS AND NO/100 (\$75,000.00) for the purpose of funding the procurement of project. The DISTRICT shall pay to COUNTY, upon invoice rendered, the sum not in excess of SEVENTY FIVE THOUSAND DOLLARS AND NO/100 (\$75,000.00) no later than sixty (60) days after the project is completed. Said funds shall be used to fund the enhancement to Doug Crane Landing as in the attached exhibits.

3. The COUNTY shall match the funding of SEVENTY FIVE THOUSAND DOLLARS AND NO/100 (\$75,000.00) the project described herein.

4. The COUNTY shall undertake the full responsibility to acquire such permits as may be required for the project and will pay the costs of procuring such permits solely from the funds provided by the DISTRICT pursuant to this Agreement.

5. The COUNTY agrees to provide such assistance and cooperation as may be required for procurement of the necessary permits issued by any local, state or federal agency exercising jurisdiction over the project and any required information necessary to complete reports as mandated by any local, state or federal agency.

6. The COUNTY shall undertake all responsibility to request and approve bids and contracts for the project and will provide to the DISTRICT such documentation as requested by the DISTRICT.

7. This agreement shall be effective upon the date of its full execution. Either party may terminate this Agreement upon thirty (30) days written notice.

8. This agreement is governed by the laws of the State of Florida. Any suit, action, or proceeding arising in connection with this agreement shall be brought in St. Johns County.

9. A certified copy of this Agreement shall be filed by the COUNTY Clerk with the Clerk of the Circuit Court of St. Johns County, Florida, as required by statute.

*****This Portion Intentionally Left Blank*****

IN WITNESS WHEREOF, the parties have caused these presents to be executed by their duly authorized officials on the dates set forth below.

ST. AUGUSTINE PORT,
WATERWAY AND BEACH
DISTRICT

ATTEST:

Printed Name: _____

Title: _____

(SEAL)

By: _____

Barry Benjamin, Chair

Date: _____

ST. JOHNS COUNTY BOARD OF
COUNTY COMMISSIONERS

ATTEST:

Brandon Patty, Clerk of Court

By: _____

Jeb S. Smith, Chair

Date: _____

(SEAL)

APPROVED AS TO FORM AND
LEGAL SUFFICIENCY:

Regina Ross, Deputy County Attorney

Attorney for District

EXHIBIT A

DOUG CRANE PARK, FLOATING DOCK
FOR
ST. JOHNS COUNTY PARKS AND REC.
ST. AUGUSTINE, FLORIDA

DEVELOPMENT INFORMATION:

DOUG CRANE PARK
PARKS AND RECREATION FLOATING DOCK
PROJECT LOCATION:
SHORE DRIVE
ST. AUGUSTINE, FL.
ZONING:
PIN: 64466-466

INDEX OF SHEETS

SHEET	DESCRIPTION
S-1	GENERAL NOTES
S-2	PROPOSED SITE PLAN
S-3	PILE LAYOUT
S-4	SECTIONS AND DETAILS

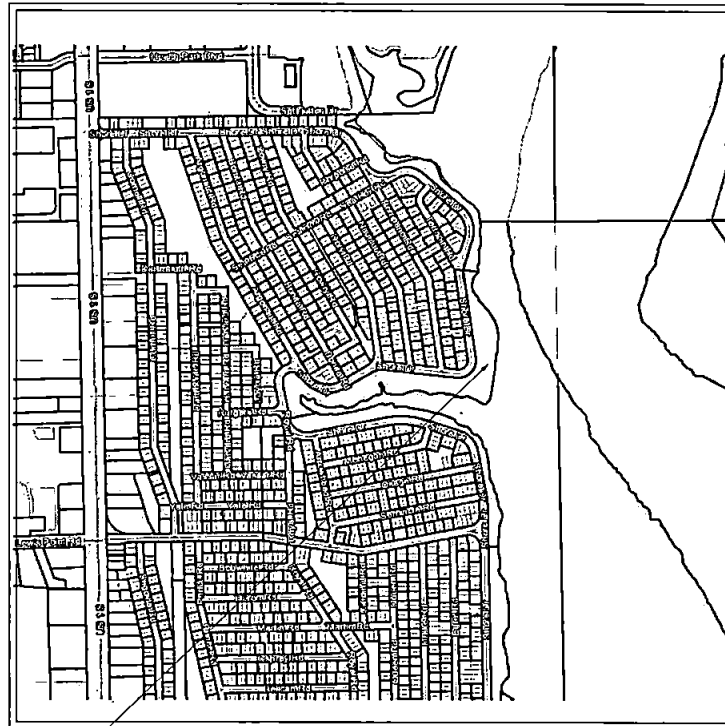

VICINITY MAP
SECTION 40, TOWNSHIP 4 SOUTH, RANGE 29 EAST

PROJECT
LOCATION
DOUG CRANE BOAT RAMP

PLANS PREPARED FOR:
BILLY ZETTS
ST. JOHNS COUNTY PARKS AND RECREATION
CONTACT NAME AND NUMBER: BILLY ZETTS 904-209-0324

PLANS PREPARED BY:



St. Johns County Public Works
2750 Industry Center Road
St. Augustine, Florida 32054
PHONE: (904) 209-0182 FAX: (904) 209-0181



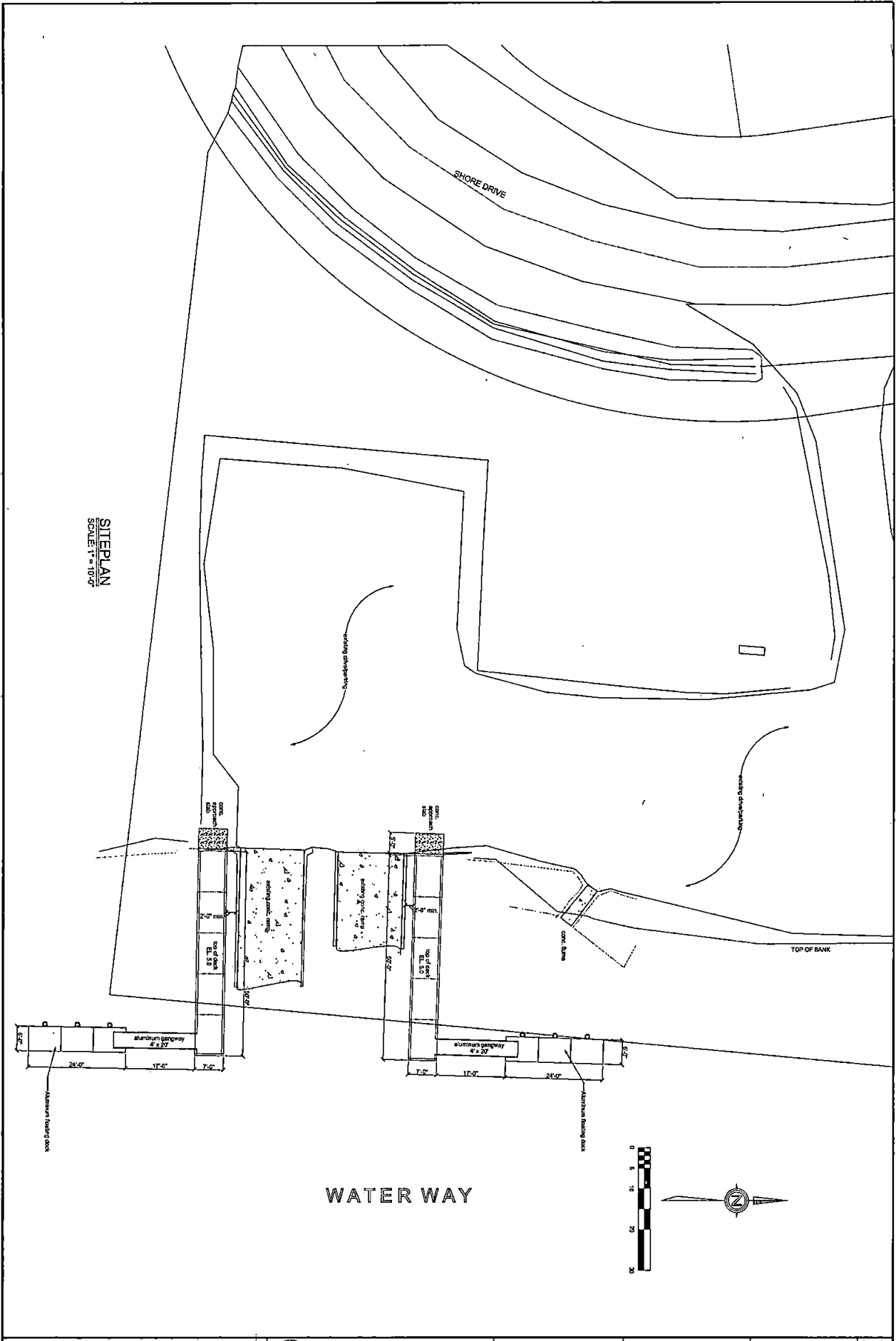

DOUG CRANE PARK
 SITE GEOMETRY PLAN

St. Johns County Public Works
 2750 Industry Center Road
 St. Augustine Florida 32054
 PHONE: (904) 209-0192 FAX: (904) 209-0181

SCALE:
 DRAWN BY: W.H.F.
 APPROVED: W.H.F.

DATE: 5/7/19
 REVISIONS:

SEAL FE # 56201
 SHEET C-1

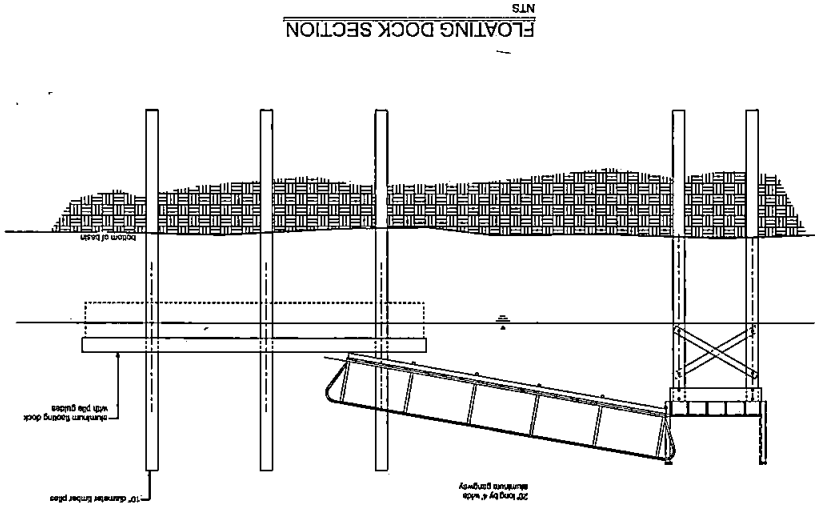

NTS
FLOATING DOCK SECTION

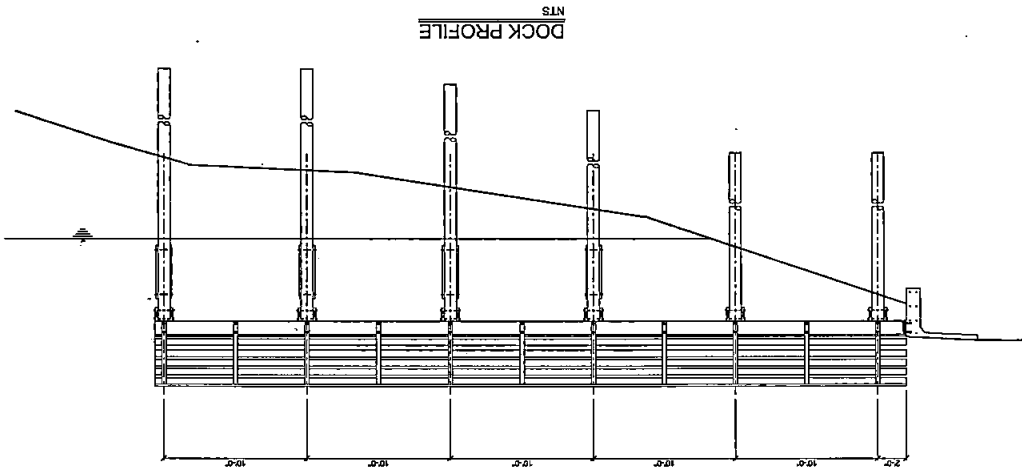

NTS
DOCK PROFILE

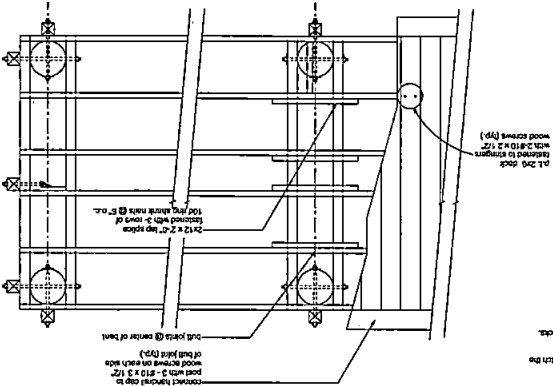

FLOATING DOCK NOTES:
The floating docks shall have aluminum pile girders with rafters to match the existing pile locations.
The floating docks shall be 10' x 60' rectangular without concrete docks.

Connect timberhead cap to wood framing on each side of raft (FP)
2x12 piles @ center of beam

2x12 x 2-0" lap splice

100 lb aluminum piles @ 2' o.c.

2x12 dock with 2x12 x 2-0" lap splice (FP)

SCALE: 3/4" = 1'-0"
BULKHEAD SECTION

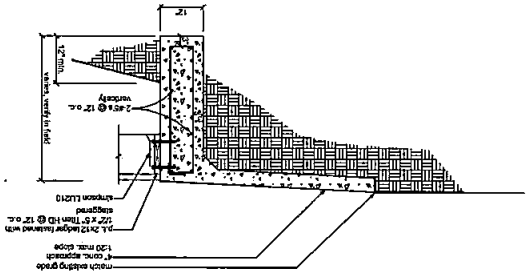

DOUG CRANE PARK
DOCK ELEVATIONS AND DETAILS



St. Johns County Public Works
2700 Healey Center Road 32084
St. Augustine, Florida 32084
Phone: (386) 208-5111 FAX: (386) 208-3311

SCALE: DRAWN BY: WHLE APPROVED: WHLE

DATE: 12/19/18 REVISIONS:

SCALE: FIG # 80001

SHEET C-3 OF

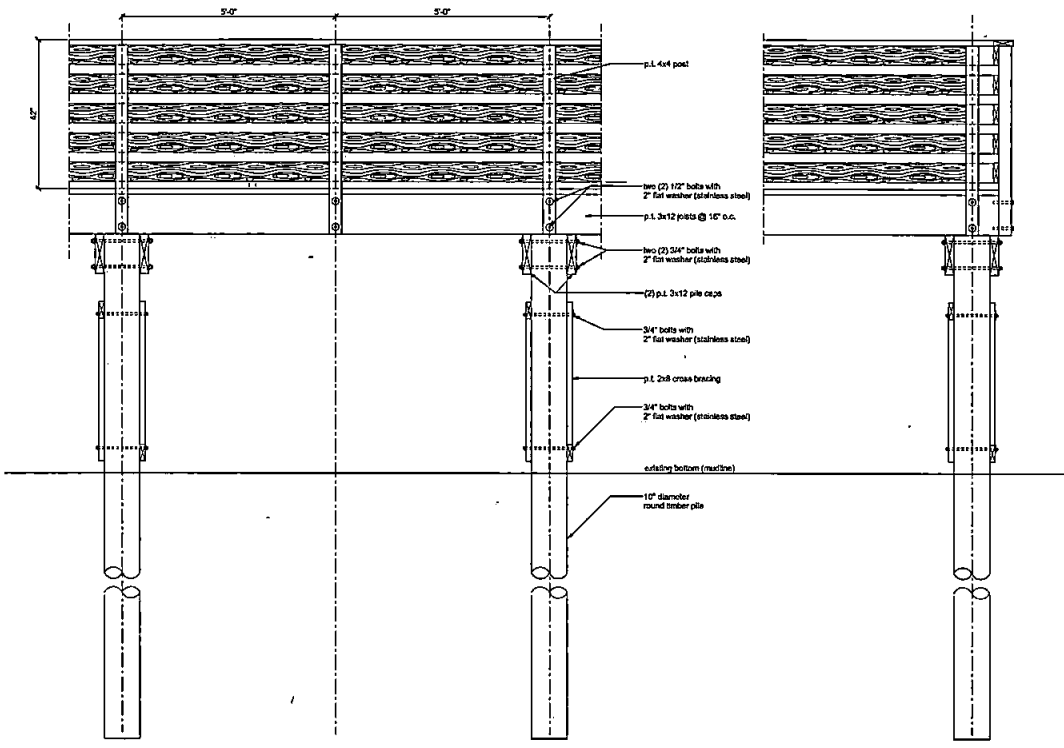

PARTIAL ELEVATION

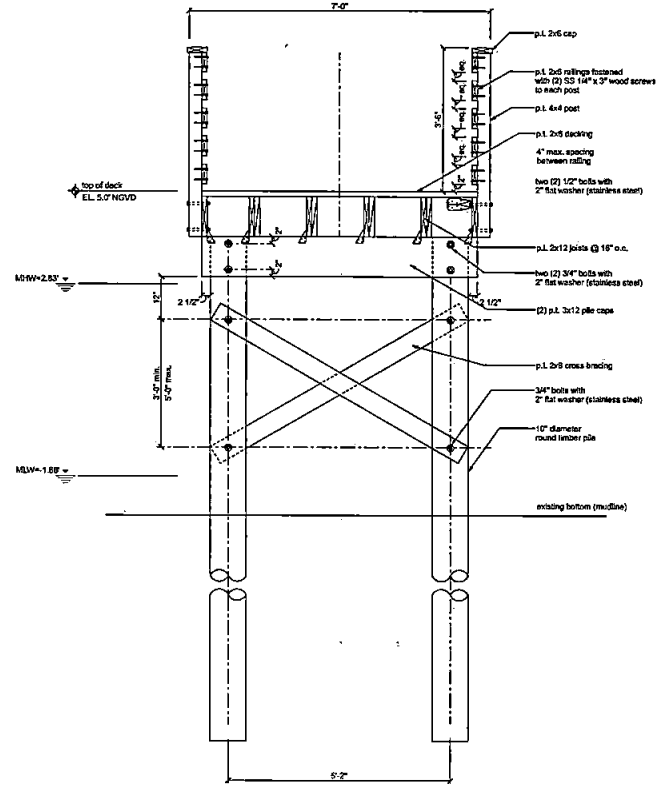

TYPICAL SECTION

WOOD FRAMING NOTES:
 1. all hardware shall be type 304 stainless steel
 2. all wood framing shall be #2 syp grade lumber
 3. all wood framing shall be CCA 0.25 minimum for wood used above ground and CCA 0.40 minimum for wood with ground contact

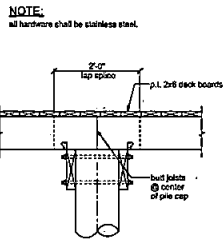

LAP SECTION
 SCALE: 3/4" = 1'-0"

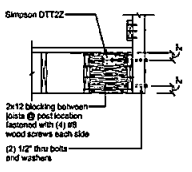

RAILING PARALLEL TO JOIST
 SCALE: 3/4" = 1'-0"

NOTE:
 all hardware shall be stainless steel.



St. Johns County Board of County Commissioners

Purchasing Division

CONTRACT TASK ORDER NO: 10
RFQ No: 17-17; Professional Services
Master Contract No: 17-MCC-GUL-08070

CONSULTANT: Gulfstream Design Group LLC
906 Anastasia Blvd., Suite A
St. Augustine, Florida 32080

Date: October 25, 2019
Project: Doug Crane Park Floating Dock and Disabled Person Parking Area

SCOPE OF WORK:

Task Order #10 is hereby issued to authorize Gulfstream Design Group LLC ("Consultant"), to design and provide a Conceptual Development Plan to install fixed access to a floating dock and disabled person parking area at Doug Crane Park, as submitted in the Consultant's proposal dated September 17, 2019, attached hereto and incorporated herein. The authorized work shall include the following tasks:

- Task 1: Conceptual Development Plan
Task 2: Concept Verification & Engineer's Opinion of Probable Cost
Task 3: Final Engineering Plans (Upland)
Task 4: Civil Plan Permitting (Upland)
Task 5: Floating Dock Layout and Plan
Task 6: Public Floating Dock Permitting
Task 7: Meetings & Public Hearings
Task 8: Limited Construction Administration
Task 8-A: Pre Construction Meeting
Task 8-B: Project Certifications
Task 9: Reimbursable Expenses

PAYMENT TERMS:

The County shall compensate the Consultant, under Task Order #10, an amount not-to-exceed eighteen thousand eight hundred thirteen dollars and seventy five cents (\$18,813.75) for work satisfactorily completed in accordance with the provisions of this task order, and with the Master Contract dated February 27, 2017.

SCHEDULE:

The Consultant shall commence work upon receipt of a fully executed Task Order. The Effective Date of this Task Order shall be the date of signature by an authorized St. Johns County Representative. Work shall be completed within one hundred twenty (120) consecutive calendar days from the Effective Date of this Task Order.

Any work performed prior to the full execution of this Task Order shall be at the Consultant's Own Risk.

ST JOHNS COUNTY
NOV 22 '19
PURCHASING

Gulfstream Design Group, LLC
DocuSigned by:
Representative: Matt Lohi
Signature:
C8E8980D06B14D5...

St. Johns County, Florida
Representative
Signature: [Handwritten Signature]

Printed Name
& Title: Matt Lahti, P.E. LEED AP

Date: 11/22/19

Printed Name Jaime T. Locklear, MPA, CPPO, CPPB, FCCM
& Title: Purchasing Manager

Date: 11/24/19

Receipt of a fully executed copy of this Task Order #10 shall serve as Notice to Proceed for this project.
All terms and conditions of the above-referenced contract dated February 27, 2017 remain in full force and effect. All invoices must reference Task Order #10. By approving this task order, the SJC Dept is certifying the availability of funds for this. Do not approve/process this task order until funds are available in the appropriate line item.

SJC Doug Crane -- Floating Docks
GDG # 19-047
September 17, 2019

SCOPE OF SERVICES

Task I: Conceptual Development Plan

Gulfstream shall coordinate with the project surveyor to obtain information in a format acceptable to Gulfstream to prepare the Conceptual Development Plan. Prior to preparation of the Conceptual Development Plan, the Client has provided Gulfstream with hand sketch drawings indicating lot dimensions, amenity locations, and access locations, etc. During Task I, Gulfstream shall determine and research the current St. Johns County future land use designation(s) and zoning on the subject site and surrounding properties in order to identify the existing entitlements on the subject site and surrounding properties.

The Conceptual Development Plan shall be based upon the footprint and preliminary information provided by the Client. The Conceptual Development Plan will show roadways, parking areas, landscape areas, buildings, storm water management areas and general site information. During Task I, Gulfstream shall coordinate with the Client's other professional consultants (surveyor, landscape architect, biologist, geotechnical engineer, architect, attorney) as necessary to review the plan for compliance with applicable regulatory agency requirements. Gulfstream shall meet with St. Johns County and FDEP staff to generate comments and revise the Concept Plan as directed by the Client, as well as St. Johns County staff. The final concept plan shall be used to generate Final Engineering Plans under Task III. All meeting time to be billed under Task VII.

HOURLY NOT TO EXCEED FEE TASK I: \$1,610.00

Task II: Concept Verification & Engineer's Opinion of Probable Cost

Pre Application meeting results should have identified any existing entitlements on the subject site and surrounding properties and the Geotechnical survey results will allow Gulfstream to coordinate with the Client's other professional consultants as necessary to review the plan for compliance with applicable regulatory agency requirements. Gulfstream shall meet with St. Johns County staff to generate comments and revise the Concept Plan as directed by the Client, as well as St. Johns County staff.

Gulfstream will also provide Engineers Opinion of Probable Cost upon completion of the Conceptual Development Plan per any revisions as required based on findings uncovered from the Geotechnical Exploration report/findings.

HOURLY NOT TO EXCEED FEE TASK II: \$965.00

Task III: Final Engineering Plans (Upland)

Task III includes the preparation of Final Engineering Plans necessary for permitting and construction purposes. Gulfstream shall prepare Final Engineering Plans for Civil site improvements, including Paving, Grading and Drainage in accordance with St. Johns County Land Development Code. Final Engineering Plans shall be based upon the Client approved Preliminary Engineering Plan. Grading plans will be generated based upon Client provided docking footprint/pads for establishment of final finished floor elevations as well as driveway, sidewalk and pavement grades.

THE REST OF THIS PAGE WAS INTENTIONALLY LEFT BLANK.

SJC Doug Crane – Floating Docks
GDG # 19-047
September 17, 2019

Cover Sheet/General Notes

The cover sheet includes plan contents, vicinity map, legal description and team identification per St. Johns County standards.

Existing Conditions Plan

Including the boundary, topographic, and tree survey as prepared by project surveyor.

Demolition Plan/SWPPP/Clearing and Erosion Control Plans

Gulfstream Design Group, LLC. will develop a Demolition Plan for the removal of any existing parking areas: loading areas, existing landscaped areas, asphalt, curbing, sidewalks, light standards, and utilities. Which may need to be removed/relocated to allow for the proposed construction. Any permits associated with demolition or removal of electrical, soft utilities, gas lines, tanks or structures, contaminated soil or materials are excluded from this scope of work.

Site Geometry Plan

Gulfstream Design Group, LLC. will prepare a Site Plan based on the Owner approved Preliminary Engineering Plan, with associated lot layout, roadway centerline geometry and other applicable infrastructure. Site Plan may include the following as applicable to the subject project: site geometry, building setbacks; roadway and right of way dimensions including; sidewalks and common area landscape locations and dimensions; storm water detention area locations and dimensions; boundary dimensions; lot dimensions; dimensions and locations of pedestrian walks; signing and marking design including directional signage; traffic signage, pavement marking including stop bars; directional arrows; parking striping and specifications. As well as applicable tracts and easements to be included on the future plat for the subject development. This Agreement excludes any offsite improvements, plans or permits along / with the FDOT right of way (outside of parcel limits)

Grading Plan

Gulfstream will prepare a final grading plan for the developed portions of the site. This will include establishing contour lines, spot grades, and slopes necessary to provide adequate surface drainage from the improved areas. Gulfstream will prepare a plan view for the site grading systems to accommodate the proposed project, roadway layout including pavement structural section as provided by Project Geotechnical Engineer; subgrade treatment; curbs, sidewalks, driveway connections, spot elevations and elevation contours; interfacing from paved surfaces to finished floor elevations; and construction details and specifications, and includes erosion and sedimentation control measures. Any offsite storm water drainage basin analysis, Joint Use Storm water Pond Agreements, Maintenance Agreements shall be considered Additional Services and performed under separate agreement.

Details

Included in the construction documents will be additional information needed to permit and construct the proposed facility. This will include construction details, typical sections, construction notes, etc., relative to the above design tasks.

HOURLY NOT TO EXCEED FEE TASK III: \$2,540.00

SJC Doug Crane – Floating Docks
GDG # 19-047
September 17, 2019

Task IV: Civil Plan Permitting (Upland)

Task IV includes the preparation of Permit Applications necessary for the ability to commence construction of the civil site and landscape improvements. After commencement of Final Engineering Plans, any substantial deviations to the plans (owner or agency driven) shall be performed under a separate agreement. The fee for Task VI includes the preparation of permit applications and initial submittal to the regulatory agencies. All meetings shall be performed under Task VII and response to comments shall be performed under this task. Gulfstream shall prepare permit applications for Client's signature for the following regulatory agencies (Client to provide Gulfstream permit application fees prior to submittal):

- SJRWMD (ERP) Environmental Resource Permit Exemption (for upland work)
- St. Johns County COMM Permit

HOURLY NOT TO EXCEED FEE TASK IV: \$2,300.00

Task V: Floating Dock Layout and Plan

In accordance with the client's schedule to obtain permits, Gulfstream shall coordinate with Project Biologist to prepare environmental permit applications to the applicable regulatory agencies, client to provide permit application fees prior to submittal. This task shall include response to Requests for Additional Information to obtain permits for a public floating dock based on plan shown in Exhibit A. Client to provide AutoCAD files of these dock plans. Client or Client's representative will sign the construction plans for permit of the structural components of the floating dock.

It is anticipated that the proposed public floating dock will not require any dredging of the seafloor, will not provide fuel, will not provide space for liveboards, nor will direct impacts to saltmarsh and/or oyster beds occur.

Gulfstream shall coordinate with the project team to provide AutoCAD drafting assistance as it relates to the public floating dock layout. Structural/Coastal Engineering needs for the public floating dock (if required) are excluded from this proposal as a part of Gulfstream's services.

HOURLY NOT TO EXCEED FEE TASK V: \$1,180.00

Task VI: Public Floating Dock Permitting

In accordance with the client's schedule to obtain permits, Gulfstream shall prepare environmental permit applications to the SJRWMD. Client shall provide Gulfstream permit application fees prior to submittal. This task shall include response to Requests for Additional Information to obtain permits for a residential public floating dock with approximately 5 wet slips from the following agencies below. It is anticipated that the proposed dock will not require any dredging of the seafloor, will not provide fuel, will not provide space for liveboards, nor will have direct impacts to saltmarsh and/or oyster beds. Minor impacts due to shading are assumed.

St. Johns River Water Management District

It is anticipated that the public floating dock will be jurisdictional to the SJRWMD. This proposal includes providing the required responses to comments generated as relate to the floating dock layout as required in the Statewide Environmental

SJC Doug Crane -- Floating Docks
GDG # 19-047
September 17, 2019

Resource Permit Application Process. Permit application will be prepared by Gulfstream in conjunction with the Environmental Consultant.

HOURLY NOT TO EXCEED FEE TASK VI: \$3,175.00

Task VII: Meetings & Public Hearings

The need will arise for Gulfstream to attend meetings as requested by the Client and as required to advance the general development goals of the project, and to provide other miscellaneous tasks not specifically listed in the scope above. Additional Services will be performed under Individual Addendums to this Agreement.

Gulfstream will coordinate and attend meetings with the Client, Client's agents, and regulatory agency, as requested by Client and/or required for the review processes. Gulfstream will attend and make presentations necessary before agency regulatory staff, hearing officers, boards and/or neighborhood associations and other agencies as outlined below:

- One (1) Pre-application / coordination meeting with each agency (SJRWMD, St. Johns County DRC)
- Two (2) Design Review meetings with Client and/or Design Team at Gulfstream's office

HOURLY NOT TO EXCEED FEE FOR TASK VII: \$2,230.00

Task VIII: Limited Construction Administration

VIII-A. PRE-CONSTRUCTION MEETING

Gulfstream will attend and conduct a preconstruction meeting with the contractor, subcontractors, regulatory agencies, and the city. The preconstruction meeting provides a venue to describe the project and answer contractor questions concerning any technical aspects of the work. In addition, Gulfstream will discuss other issues including lines of engineer and contractor communication, general and specific contract conditions, contract administration, site visits and progress meetings, progress payment, correspondence procedures, project schedule, and general site safety. We will record minutes of the preconstruction meeting discussions and distribute them to the attendees. This meeting will occur after the Notice to Award and before the Notice to Proceed. We will provide 2-hour of-site preparation and 1- hour on site preconstruction meeting services with 2-staff attending the meeting.

FEE TASK VIII-A: HOURLY NOT TO EXCEED \$ 1,350.00

VIII-B: PROJECT CERTIFICATIONS

Once the city receives the contractor's request to certify the project as substantially complete, we will visit the project site determine the degree of completion. If we cannot certify substantial completion, we will develop preliminary and final punch lists of items for the contractor to complete or correct. With concurrence from the city, we will transmit this list to the contractor. Upon completion of outlined items, we will certify the project substantially complete. We have budgeted for two on-site meetings for this task. This task does not constitute construction site observations; if requested on a regular basis, these services can be provided under separate proposal.

SJC Doug Crane – Floating Docks
GDG # 19-047
September 17, 2019

We will collect and review the following information from the contractor before project closeout:

- SJC Closeout Documents (DRC)
- SJRWMD / FDEP Closeout Documents

Fee Task VIII-B: Hourly Not To Exceed \$2,500.00

Should additional services be required, they can be furnished with compensation based on the Schedule of Hourly Rates contained in the attached General Terms and Conditions. Similarly, in the event that modifications to the Construction Plans are required by the Client or Project Architect, which differ from the approved Plans, the modifications shall be considered additional service, and compensation shall be in accordance with the attached Schedule of Hourly Rates.

Please refer to the attached General Terms and Conditions, which is incorporated by reference into this Contract for Professional Services. This Contract for Professional Services, and the attached Standard Conditions form, contain all the terms of the agreement.

Task IX: REIMBURSABLE EXPENSES

Gulfstream will provide printing and other services which require reimbursement to include but not limited to: Plotting of Construction Plans for submittal to the regulatory agencies, printing of calculations/reports/maps/exhibits, mileage to and from the project site, as well as other expenses required to achieve the client's goals. St. Johns County agrees to reimburse Gulfstream for all out-of-pocket expenses associated with the services provided in the Agreement. The reimbursable expenses cover the tasks in the initial agreement as well as the tasks in this change order but exclude reimbursable expenses on any future tasks which may be required to achieve the client's goals.

Item	\$ per unit	unit	total
24X36 BLACK & WHITE	\$1.75	250	\$437.50
8.5X11 BLACK & WHITE	\$0.15	1000	\$150.00
8.5X11 COLOR	\$0.30	150	\$45.00
11X17 BLACK & WHITE	\$0.50	250	\$125.00
11X17 COLOR	\$0.75	75	\$56.25
Postage/Courier	\$10.00	15	\$150.00
TOTAL			\$963.75

Fee Task IX: Fee Not To Exceed \$ 963.75

Receipt of the signed contract will be considered our notice to commence work.

SJC Doug Crane -- Floating Docks
 GDG # 19-047
 September 17, 2019

Date	Doc	Task	Amt	Total
9/17/19	GDG Proposal			\$18,813.75
		I. Conceptual Development Plan	\$1,610.00	
		II. Concept Ver & Eng OoPC	\$965.00	
		III. Final Engineering Plans (Upland)	\$2,540.00	
		IV. Civil Plan Permitting (Upland)	\$2,300.00	
		V. Floating Dock Layout & Plan	\$1,180.00	
		VI. Public Floating Dock Permitting	\$3,175.00	
		VII. Meetings & Public Hearings	\$2,230.00	
		VIII. A - Pre-Construction Meeting	\$1,350.00	
		B - Project Certifications	\$2,500.00	
		IX. Reimbursables	\$963.75	
		TOTAL		

Information to be provided by the Client: Client's Responsibilities

1. Designate in writing a person to act as its representative with respect to this agreement, such person having complete authority to transmit instructions, receive information, and make or interpret the Client's decisions.
2. Provide all information and criteria as to the Client's requirements, objectives, and expectations for the project including all numerical criteria that are to be met and all standards of development, design, or construction.
3. Provide to the Consultant all previous studies, plans, or other documents pertaining to the project and all new data reasonably necessary in the Consultant's opinion, such as site survey and engineering data, environmental impact assessments or statements, upon all of which the Consultant may rely.
4. Arrange for access to the site and other private or public property as required for the Consultant to provide its services.
5. Review all documents or oral reports presented by the Consultant and render in writing decisions pertaining thereto within a reasonable time so as not to delay the services of the Consultant.
6. Furnish approvals and permits from governmental authorities having jurisdiction over the project and approvals and consents from other parties as may be necessary for completion of the Consultant's services.
7. Cause to be provided such independent accounts, legal, insurance services as the Client may require.
8. Give prompt written notice to the Gulfstream whenever the Client becomes aware of any development that affects the scope, timing, or payment of the Consultant's services or any defect or noncompliance in any aspect of the project.
9. Bear all costs incidental to the responsibilities of the Client.

Gulfstream Initials _____

Client Initials _____

SJC Doug Crane – Floating Docks
GDG # 19-047
September 17, 2019

SERVICES NOT INCLUDED:

- Surveying Services (Tree, Boundary, Topographic, Hydrographic)
- Preparation of Easements or Legal Descriptions
- Landscape/Tree Mitigation/ Irrigation Plans
- Traffic Impact Studies / Traffic Engineering / Signal Warrant Study
- Biological Services (Wetland Flagging, ACOE Permitting, Mitigation Assessments)
- Structural Engineering Services (Pilings, Docks, Boat Ramps)
- Geotechnical Engineering Services
- Signalization Design / Warrant Study/ Turn Lane (Offsite)
- Architectural Services
- Legal Services
- Site Lighting/Electrical Design
- Fire main/fire system design
- FEMA Map Revisions
- Water Quality Monitoring/NDPES Inspections
- Color Renderings/Elevations
- Financial Institution & Special Uses Documentation
- Construction Specification Manual
- Arbor services/ Protected species studies
- Detailed Earthwork estimating
- Global Positioning System location services
- Department of Health Permits
- Submersible Well Design
- Design of onsite Stormwater Collection System
- Design of Stormwater Management System (Treatment/Attenuation)
- Onsite Utility Extension Design (potable water and wastewater)
- Florida Department of Environmental Protection Permits (Water/Wastewater/Stormwater)
- Lift Station Design (Wastewater and Stormwater)
- Commercial Swimming Pool Design
- Phase I/II Environmental Studies
- Onsite Restrooms/Preparation of Utility Plans
- Florida Department of Transportation Permits (Driveway/Drainage/Utility)
- Utility Design
- Restroom Design
- Parking Lot Design
- Recreation Area Design

THE REST OF THIS PAGE WAS INTENTIONALLY LEFT BLANK.

Gulfstream Initials _____

Client Initials _____

Man-Hour Spreadsheet

SJC DOUG CRANE PARK - Floating Dock
GDG #19-047

Project Name:	SJC Doug Crane Park-Floating Docks & Handicap Par	Professional Engineer	Project Engineer	AutoCAD Technician	Technical Assistant	Project Admin	Subtotals per task	
Project #:	GDG # 19-047							
Task:	Task Description	Hrly Rate:	\$ 125.00	\$ 95.00	\$ 85.00	\$ 45.00	\$ 60.00	
Task I	Conceptual Development Plan		2.00		16.00		\$ 1,610.00	
Task II	Concept Verification & EOoPC		5.00		4.00		\$ 965.00	
Task III	Final Engineering Plans (Upland)		4.00		24.00		\$ 2,540.00	
Task IV	Civil Plan Permitting (Upland)		8.00		4.00	16.00	\$ 2,300.00	
Task V	Floating Dock Layout and Plan		4.00		8.00		\$ 1,180.00	
Task VI	Public Float Dock Permitting		15.00		4.00	16.00	\$ 3,175.00	
Task VII	Meetings & Public Hearings		10.00	4.00		8.00	\$ 2,230.00	
Task VIII-A	Limited Construction Administration		2.00	8.00	4.00		\$ 1,350.00	
Task VIII-B	Project Certifications		6.00	16.00	2.00	1.00	\$ 2,500.00	
Task IX	Reimbursables	963.75					\$ 963.75	
							\$	
							\$	
							\$	
							\$	
	Total Manhours (hrs.)		56.0	28.0	66.0	40.0	13.0	203.0
	Total REIMBURSABLES							
	Total Fee	963.75	7000	2,660.00	5,610.00	1,800.00	780.00	\$ 18,813.75

PURCHASING REQUEST FORM

Date: 10/22/19

Department: Construction Services

Contact/Project Mgr: Bill Freeman

Dept Head Approval: JDuane Kent

Task Order

Change Order

Amendment

Bid/RFP/RFQ #: 17-19-06

Vendor Name: Gulfstream

Amount Budgeted: \$18,813.75

Cost/GL Code(s): 0080-56301 0080-55305

Proposal Attached: yes (Yes or No)

Completion Time: 120 days

or Contract Time Increase/Decrease:

(Number of Days)

Scope of Work:

Engineering services Doug Crane Park floating dock

Reason for Change: (Change Orders and Amendments Only)

Important Info:

CDG #18042

Submit Form



St. Johns County Board of County Commissioners

Purchasing Division

November 25, 2019

Gulfstream Design Group LLC
906 Anastasia Blvd, Suite A
St. Augustine, FL 32080

RE: RFQ No: 17-17 – Professional Services
Master Contract No: 17-MCC-GUL-08070 – Task Order No: 10

Dear Ms. DeLisle:

Enclosed, please find a fully executed original copy of Task Order No: 10 for your files.

If you have any questions regarding this contract, you may contact me at the information below.

Thank you for doing business with St. Johns County.

Sincerely,
St. Johns County, FL
Purchasing Department

A handwritten signature in black ink, appearing to read "Travis Hembree".

Travis Hembree
Procurement Coordinator
(904) 209-0156 – Direct
(904) 209-0157 – Fax
thembree@sjcfl.us

CC: SJC Minutes & Records
SJC Purchasing RFQ 17-17 – Gulfstream Design Group Master Contract File